

**NOTICE!!**

**These documents have been scanned!**

**Do not place un-scanned documents beneath this notice!**

**Do not remove this notice from this file!**

GPO Jacket No. 560-102  
Print Order 61540  
Rise Business Services, LLC  
Job=AZ15 5/21/2019



Box Number= AZ15075



Claim Begin-End: AMC452645-AMC452666

**1 Initial Receipt**

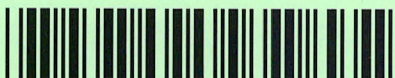

AZ15075-25

AMC452444-AMC452831

**United States Department of the Interior**  
**Bureau of Land Management**  
 DIV OF LANDS, MINRLS & ENERGY  
 ONE N CENTRAL AVE  
 PHOENIX, AZ 85004 -4427  
 Phone: 602-417-9200

Receipt

No: 4327424

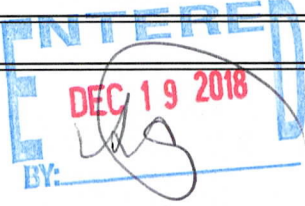
<b>Transaction #:</b> 4444040	
<b>Date of Transaction:</b> 12/06/2018	
CUSTOMER:	
AMAZONA ENTERPRISES INC 1846 E INNOVATION PARK DR STE 100 ORO VALLEY, AZ 85755-1963 US	

LINE #	QTY	DESCRIPTION	REMARKS	UNIT PRICE	TOTAL
1	22.00	LOCATABLE MINERALS / MINING CLAIMS- NEW, UNADJUD, ONE OR MORE AUTH NOS / NEW MINING CLAIM PROCESSING FEE <b>CASES:</b> AMC452645/\$20.00, AMC452646/\$20.00, AMC452647/\$20.00, AMC452648/\$20.00, AMC452649/\$20.00, AMC452650/\$20.00, AMC452651/\$20.00, AMC452652/\$20.00, AMC452653/\$20.00, AMC452654/\$20.00, AMC452655/\$20.00, AMC452656/\$20.00, AMC452657/\$20.00, AMC452658/\$20.00, AMC452659/\$20.00, AMC452660/\$20.00, AMC452661/\$20.00, AMC452662/\$20.00, AMC452663/\$20.00, AMC452664/\$20.00, AMC452665/\$20.00, AMC452666/\$20.00		- n/a -	440.00
2	22.00	LOCATABLE MINERALS / MINING CLAIMS- NEW, UNADJUD, ONE OR MORE AUTH NOS / NEW MINING CLAIMS LOCATION FEE <b>CASES:</b> AMC452645/\$37.00, AMC452646/\$37.00, AMC452647/\$37.00, AMC452648/\$37.00, AMC452649/\$37.00, AMC452650/\$37.00, AMC452651/\$37.00, AMC452652/\$37.00, AMC452653/\$37.00, AMC452654/\$37.00, AMC452655/\$37.00, AMC452656/\$37.00, AMC452657/\$37.00, AMC452658/\$37.00, AMC452659/\$37.00, AMC452660/\$37.00, AMC452661/\$37.00, AMC452662/\$37.00, AMC452663/\$37.00, AMC452664/\$37.00, AMC452665/\$37.00, AMC452666/\$37.00		- n/a -	814.00



3	22.00	LOCATABLE MINERALS / MINING CLAIMS- NEW, UNADJUD, ONE OR MORE AUTH NOS / NEW MINING CLAIMS MAINTENANCE FEE <b>CASES:</b> AMC452645/\$155.00, AMC452646/ \$155.00, AMC452647/\$155.00, AMC452648/\$155.00, AMC452649/\$155.00, AMC452650/\$155.00, AMC452651/\$155.00, AMC452652/\$155.00, AMC452653/\$155.00, AMC452654/\$155.00, AMC452655/\$155.00, AMC452656/\$155.00, AMC452657/\$155.00, AMC452658/\$155.00, AMC452659/\$155.00, AMC452660/\$155.00, AMC452661/\$155.00, AMC452662/\$155.00, AMC452663/\$155.00, AMC452664/\$155.00, AMC452665/\$155.00, AMC452666/\$155.00	- n/a -	3410.00
<b>TOTAL:</b>				<b>\$4,664.00</b>

PAYMENT INFORMATION				
NOTE: Items will appear on credit card statement as "Bureau of Land Mgmt CO".				
1	AMOUNT:	4664.00	POSTMARKED:	N/A
	TYPE:	CREDIT CARD	RECEIVED:	12/06/2018
	NAME:	AMAZONA ENTERPRISES INC 1846 E INNOVATION PARK DR STE 100 ORO VALLEY AZ 85755-1963 US		
	CARD NO:	XXXXXXXXXXXX9007	AUTH CODE:	148101
	NAME ON CARD:	W C F		
	SIGNATURE:			

REMARKS

This receipt was generated by the automated BLM Collections and Billing System and is a paper representation of a portion of the official electronic record contained therein.

**NOTICE!!**

**These documents have been scanned!**

**Do not place un-scanned documents beneath this notice!**

**Do not remove this notice from this file!**

GPO Jacket No. 560-102  
Print Order 61540  
Rise Business Services, LLC  
Job=AZ15 5/21/2019



Box Number= AZ15075



Claim Begin-End: AMC452645-AMC452666

**2 Correspondence**



AZ15075-25

AMC452444-AMC452831



**NO  
DOCUMENTS  
FOUND**

NO DOCUMENTS FOUND  
NO DOCUMENTS FOUND

**NOTICE!!**

**These documents have been scanned!**

**Do not place un-scanned documents beneath this notice!**

**Do not remove this notice from this file!**

GPO Jacket No. 560-102  
Print Order 61540  
Rise Business Services, LLC  
Job=AZ15 5/21/2019



Box Number= AZ15075



Claim Begin-End: AMC452645-AMC452666

**3 Transfers**

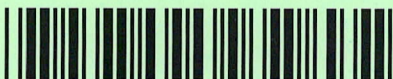

AZ15075-25

AMC452444-AMC452831



**NO  
DOCUMENTS  
FOUND**

NO DOCUMENTS FOUND  
NO DOCUMENTS FOUND

**NOTICE!!**

**These documents have been scanned!**

**Do not place un-scanned documents beneath this notice!**

**Do not remove this notice from this file!**

GPO Jacket No. 560-102  
Print Order 61540  
Rise Business Services, LLC  
Job=AZ15 5/21/2019



Box Number= AZ15075



Claim Begin-End: AMC452645-AMC452666

**4 Annual Filings**



AZ15075-25

AMC452444-AMC452831



**NO  
DOCUMENTS  
FOUND**

NO DOCUMENTS FOUND  
NO DOCUMENTS FOUND

**NOTICE!!**

**These documents have been scanned!**

**Do not place un-scanned documents beneath this notice!**

**Do not remove this notice from this file!**

GPO Jacket No. 560-102  
Print Order 61540  
Rise Business Services, LLC  
Job=AZ15 5/21/2019



Box Number= AZ15075



Claim Begin-End: AMC452645-AMC452666

**5 Miscellaneous**



AZ15075-25

AMC452444-AMC452831



**NO  
DOCUMENTS  
FOUND**

NO DOCUMENTS FOUND  
NO DOCUMENTS FOUND

**NOTICE!!**

**These documents have been scanned!**

**Do not place un-scanned documents beneath this notice!**

**Do not remove this notice from this file!**

GPO Jacket No. 560-102  
Print Order 61540  
Rise Business Services, LLC  
Job=AZ15 5/21/2019



Box Number= AZ15075



Claim Begin-End: AMC452645-AMC452666

**6 Location Notices-Amendments and Supporting Documents**



AZ15075-25

AMC452444-AMC452831



**MINING CLAIM STATUS REPORT**

Data Entered: 12/19/2018

MTP Checked By: \_\_\_\_\_

GEO Checked By: \_\_\_\_\_

LEAD SERIAL NUMBER: AMC 452645 thru AMC 452666

**NUMBER OF CLAIMS & TYPE:**

22 LODE  
\_\_\_\_ PLACER  
\_\_\_\_ ASSOCIATION PLACER  
\_\_\_\_ MILL SITE  
\_\_\_\_ TUNNEL SITE

**CHARGES:**

Processing Fee @ \$20 = \$ 440  
Location Fee @ \$37 = \$ 814  
Maintenance Fee @ \$155 = \$ 3,410  
Add'l Maint Fee for Assoc Placer = \$ \_\_\_\_\_  
**SUBTOTAL** \$ \_\_\_\_\_  
Other Fees \$ \_\_\_\_\_  
Other Fees \$ \_\_\_\_\_  
**TOTAL** \$ 4,664

TOTAL ACREAGE: \_\_\_\_\_ Per Claim  
(Placer Only)

NUMBER OF LOCATORS: \_\_\_\_\_

DOCUMENTS RECEIVED VIA : Over-the-Counter [ ] Mail [] **TIMELY FILED:** Yes [] No [ ]

LEGAL DESCRIPTION: T 23N R 18W SEC 5, 8  
T \_\_\_\_\_ R \_\_\_\_\_ SEC \_\_\_\_\_  
T \_\_\_\_\_ R \_\_\_\_\_ SEC \_\_\_\_\_  
T \_\_\_\_\_ R \_\_\_\_\_ SEC \_\_\_\_\_  
T \_\_\_\_\_ R \_\_\_\_\_ SEC \_\_\_\_\_

BLM [ ] FOREST SERVICE [ ] \_\_\_\_\_ SUBJ TO PL 359: Yes [ ] No [ ]  
WILDERNESS AREA [ ] \_\_\_\_\_

SPLIT ESTATE: N/A [ ] SX [ ] PX [ ] OTHER [ ] \_\_\_\_\_  
SRHA [ ] Was proper Notice filed if located on SHRA Land? Yes [ ] No [ ]

**RECONVEYED MINERALS ON BLM LAND REQUIRE OPENING ORDER FROM 1944 TO 1993:**

Open to Entry On \_\_\_\_\_ N/A [ ]

COMMENTS/STATUS: VOID [ ] PARTIALLY VOID [ ] PVT MINERALS [ ] WITHDRAWN LANDS [ ]  
OTHER [ ] \_\_\_\_\_

AMC 452645

[ ] Claimant acknowledges that portions of the following claim(s) site(s) may be void or voidable.

Printed Name of Claimant \_\_\_\_\_ Signature of Claimant \_\_\_\_\_

\*\*\*\*\*FINAL ADJUDICATION\*\*\*\*\*

DATE \_\_\_\_\_ INITIALS \_\_\_\_\_

FEE# 2018059299

OFFICIAL RECORDS  
OF MOHAVE COUNTY  
KRISTI BLAIR,  
COUNTY RECORDER



11/30/2018 03:26 PM Fee: \$10.00

PAGE: 1 of 2

2

**LOCATION NOTICE FOR LODE MINING CLAIM**

Amendment BLM Serial # \_\_\_\_\_

NOTICE IS HEREBY GIVEN that the CHL - 1 lode mining claim has been located by Amazona Enterprises whose current mailing address is

1846 E. Innovation Park Dr. STE 100  
Oro Valley, AZ 85755.

The general course of this claim is north-south and it is situated in Mohave County, Arizona. This claim is 1500 feet in length and 600 feet in width. 20 Total Claim Acreage.

This claim runs from the location monument on which this location notice is posted on the centerline of the claim approximately 100 feet in a south direction to the south end line and 300 feet in a west direction to the west end line and 1500 feet north to the north end line and 600 feet east to the east end line and 1500 feet south to the south end line. This claim is marked by six monuments, one at each corner and one at the center of each end line of the claim.

The location monument on which this notice is posted is situated within Section 5 in Township 23 North and Range 18 W, Gila Salt River Base and Meridian (GSRBM), Arizona and this claim encompasses portions of the following quarter section(s), section(s), Township(s) and Range(s) SW AND NW ¼ of Section 5 in Township 23 N, R 18 W of the GSRBM, Arizona.

The locality of this claim with reference to some natural object or permanent monument and additional information (if any) concerning its locality are as follows:  
1,625 feet N 11° E from the SW corner of Section 5 in T 23 N, R 18 W of the GSRBM.

The above information is shown on the attached map.

DATED AND POSTED on the ground this 17 day of September, 2018.

LOCATOR(s)  AGENT

Print Name(s) William Feyerabend  
Signature(s) William Feyerabend

RECEIVED  
BLM AZ STATE OFFICE  
2018 DEC - 3 P 3:05  
PHOENIX, ARIZONA

AMC452645



RECEIVED  
BLM AZ STATE OFFICE  
2010 DEC - 3 P 3:05  
PHOENIX, ARIZONA

**MINING CLAIM MAP**

Lode ( )

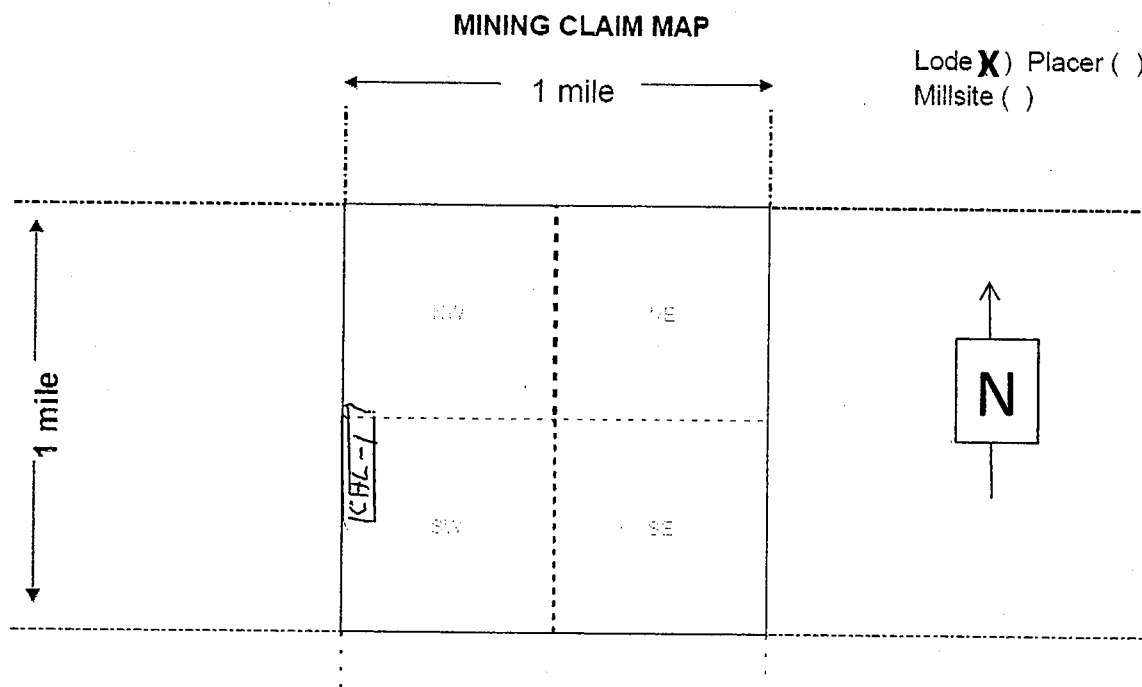

AMC4526451

1. The above map depicts the CHL-1 mining claim, which is located in Section 5, Township 23 N., Range 18 W, Gila and Salt River Base and Meridian, Mohave County, Arizona. Total claim acreage is 20.
2. The type of corner and location monuments used are as follows: 2" X 2" X 4' wooden posts
3. The bearings and distances in degrees and feet between this location monument and a public land survey monument is 1,625 feet N 11° E from the SW corner of Sec. 5, T. 23 N., R. 18 W., GSRBM. as depicted on the map.

FEE# 2018059300

OFFICIAL RECORDS  
OF MOHAVE COUNTY  
KRISTI BLAIR,  
COUNTY RECORDER



11/30/2018 03:26 PM Fee: \$10.00

PAGE: 1 of 2

2

LOCATION NOTICE FOR LODE MINING CLAIM

Amendment BLM Serial # \_\_\_\_\_

NOTICE IS HEREBY GIVEN that the CHL - 2 lode mining claim has been located by Amazona Enterprises whose current mailing address is

1846 E. Innovation Park Dr. STE 100  
Oro Valley, AZ 85755.

The general course of this claim is north-south and it is situated in Mohave County, Arizona. This claim is 1500 feet in length and 600 feet in width.  
20 Total Claim Acreage.

RECEIVED  
BLM AZ STATE OFFICE  
2018 DEC - 3 P 3:05  
PHOENIX, ARIZONA

This claim runs from the location monument on which this location notice is posted on the centerline of the claim approximately 100 feet in a south direction to the south end line and 300 feet in a west direction to the west end line and 1500 feet north to the north end line and 600 feet east to the east end line and 1500 feet south to the south end line. This claim is marked by six monuments, one at each corner and one at the center of each end line of the claim.

The location monument on which this notice is posted is situated within Section 5 in Township 23 North, Range 18 W, Gila Salt River Base and Meridian (GSRBM), Arizona and this claim encompasses portions of the following quarter section(s), section(s), Township(s) and Range(s) SW AND NW ¼ of Section 5 in Township 23 N, R 18 W of the GSRBM, Arizona.

The locality of this claim with reference to some natural object or permanent monument and additional information (if any) concerning its locality are as follows:  
1,833 feet N 29° E from the SW corner of Section 5 in T 23 N and R 18 W of the GSRBM.

The above information is shown on the attached map.

DATED AND POSTED on the ground this 12 day of September, 2018.

LOCATOR(s)  AGENT

Print Name(s) William Feyerabend  
Signature(s) William Feyerabend

AMC452646



RECEIVED  
 BLM AZ STATE OFFICE  
 2018 DEC - 3 P 3:05  
 PHOENIX, ARIZONA

**MINING CLAIM MAP**

Lode ( )

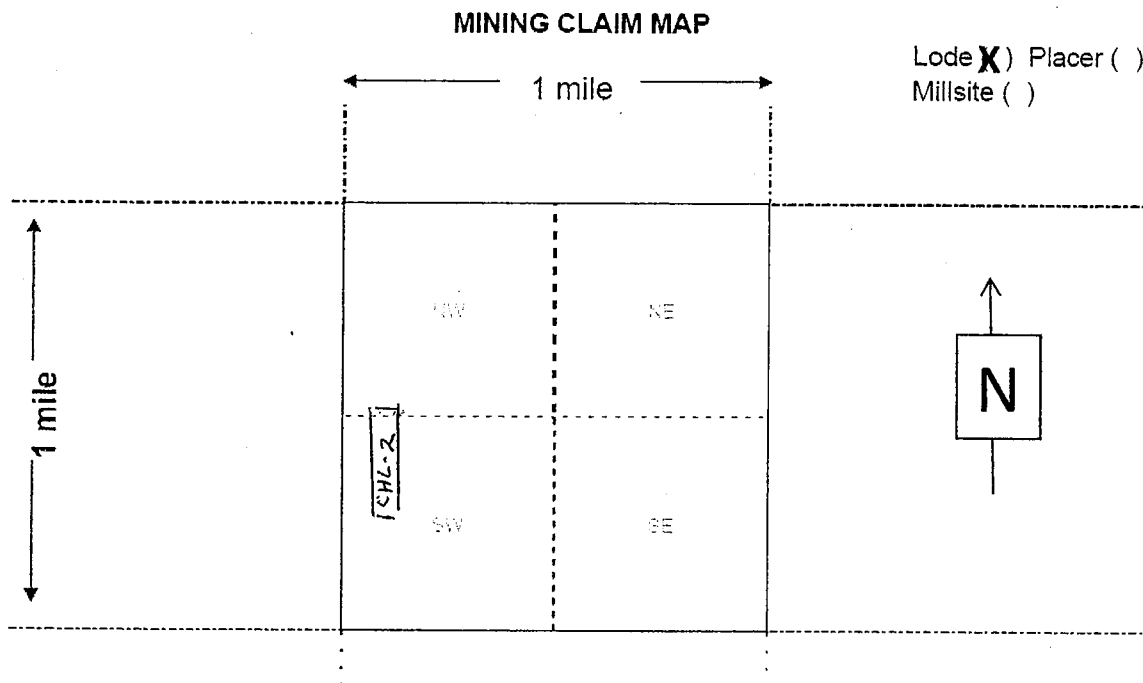

AMC452646

1. The above map depicts the CHL-2 mining claim, which is located in Section (s) 5, Township 23 N, Range 18 W, Gila and Salt River Base and Meridian, Mohave County, Arizona. Total claim acreage is 20.
2. The type of corner and location monuments used are as follows: 2" X 2" X 4' wooden posts
3. The bearings and distances in degrees and feet between this location monument to a public land survey monument is 1,833 feet N 29° E from the SW corner of Sec. 5, T. 23 N., R. 18 W., GSRBM. as depicted on the map.



FEE# 2018059301

OFFICIAL RECORDS  
OF MOHAVE COUNTY  
KRISTI BLAIR,  
COUNTY RECORDER



11/30/2018 03:26 PM Fee: \$10.00

PAGE: 1 of 2

2

**LOCATION NOTICE FOR LODE MINING CLAIM**

Amendment BLM Serial # \_\_\_\_\_

NOTICE IS HEREBY GIVEN that the CHL - 3 lode mining claim has been located by Amazona Enterprises whose current mailing address is

1846 E. Innovation Park Dr. STE 100  
Oro Valley, AZ 85755.

The general course of this claim is north-south and it is situated in Mohave County, Arizona. This claim is 1500 feet in length and 600 feet in width.

20 Total Claim Acreage.

RECEIVED  
BLM AZ STATE OFFICE  
2018 DEC - 3 P 3:05  
PHOENIX, ARIZONA

This claim runs from the location monument on which this location notice is posted on the centerline of the claim approximately 100 feet in a north direction to the north end line and 300 feet in a west direction to the west end line and 1500 feet south to the south end line and 600 feet east to the east end line and 1500 feet north to the north end line. This claim is marked by six monuments, one at each corner and one at the center of each end line of the claim.

The location monument on which this notice is posted is situated within Section 5 in Township 23 North, Range 18 W, Gila Salt River Base and Meridian (GSRBM), Arizona and this claim encompasses portions of the following quarter section(s), section(s), Township(s) and Range(s) SW 1/4 of Section 5 in Township 23 N, R 18 W of the GSRBM, Arizona.

The locality of this claim with reference to some natural object or permanent monument and additional information (if any) concerning its locality are as follows:

1,432 feet N 12° E from the SW corner of Section 5 in T 23 N and R 18 W of the GSRBM.

The above information is shown on the attached map.

DATED AND POSTED on the ground this 12 day of September, 2018.

LOCATOR(s)  AGENT

Print Name(s) William Feyerabend  
Signature(s) William Feyerabend

AHC452647



RECEIVED  
BLM AZ STATE OFFICE  
2010 DEC - 3 P 3:05  
PHOENIX, ARIZONA

### MINING CLAIM MAP

Lode ( )

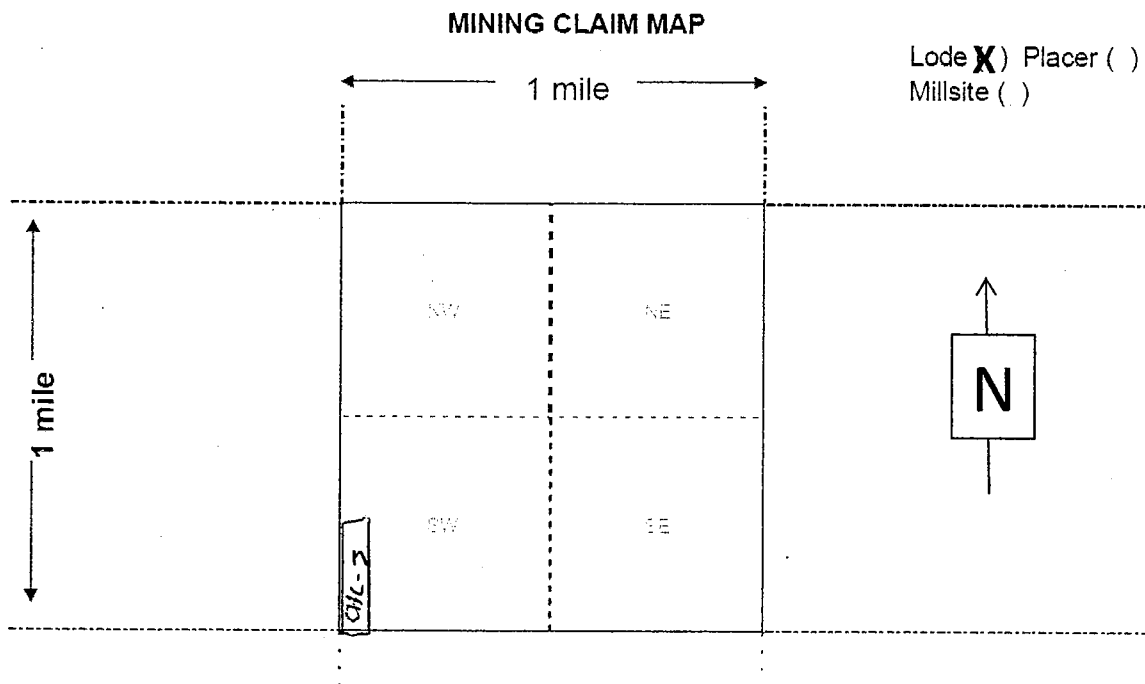

AMC452647

1. The above map depicts the CHL-3 mining claim, which is located in Section 5, Township 23 N , Range 18 W, Gila and Salt River Base and Meridian, Mohave County, Arizona. Total claim acreage is 20.
2. The type of corner and location monuments used are as follows: 2" X 2" X 4' wooden posts
3. The bearings and distances in degrees and feet between this location monument to a public land survey monument is 1,432 feet N 12° E from the SW corner of Sec. 5, T. 23 N., R. 18 W., GSRBM. as depicted on the map.

FEE# 2018059302

OFFICIAL RECORDS  
OF MOHAVE COUNTY  
KRISTI BLAIR,  
COUNTY RECORDER



11/30/2018 03:26 PM Fee: \$10.00

PAGE: 1 of 2

2

**LOCATION NOTICE FOR LODE MINING CLAIM**

Amendment BLM Serial # \_\_\_\_\_

NOTICE IS HEREBY GIVEN that the CHL - 4 lode mining claim has been located by Amazona Enterprises whose current mailing address is

1846 E. Innovation Park Dr. STE 100  
Oro Valley, AZ 85755.

The general course of this claim is north-south and it is situated in Mohave County, Arizona. This claim is 1500 feet in length and 600 feet in width.  
20 Total Claim Acreage.

This claim runs from the location monument on which this location notice is posted on the centerline of the claim approximately 100 feet in a north direction to the north end line and 300 feet in a west direction to the west end line and 1500 feet south to the south end line and 600 feet east to the east end line and 1500 feet north to the north end line. This claim is marked by six monuments, one at each corner and one at the center of each end line of the claim.

The location monument on which this notice is posted is situated within Section 5 in Township 23 North, Range 18 W, Gila Salt River Base and Meridian (GSRBM), Arizona and this claim encompasses portions of the following quarter section(s), section(s), Township(s) and Range(s) SW ¼ of Section 5 in Township 23 N, R 18 W of the GSRBM, Arizona.

The locality of this claim with reference to some natural object or permanent monument and additional information (if any) concerning its locality are as follows:  
1,664 feet N 13° E from the SW corner of Section 5 in T 23 N and R 18 W of the GSRBM.

The above information is shown on the attached map.

DATED AND POSTED on the ground this 12 day of September, 2018.

LOCATOR(s)  AGENT

Print Name(s) William Feyerabend

Signature(s) William Feyerabend

RECEIVED  
BLM AZ STATE OFFICE  
2018 DEC - 3 P 3:00  
PHOENIX, ARIZONA

AHC452648



RECEIVED  
 BLM AZ STATE OFFICE  
 2018 DEC - 3 P 3:06  
 PHOENIX, ARIZONA

**MINING CLAIM MAP**  
 Lode ( )

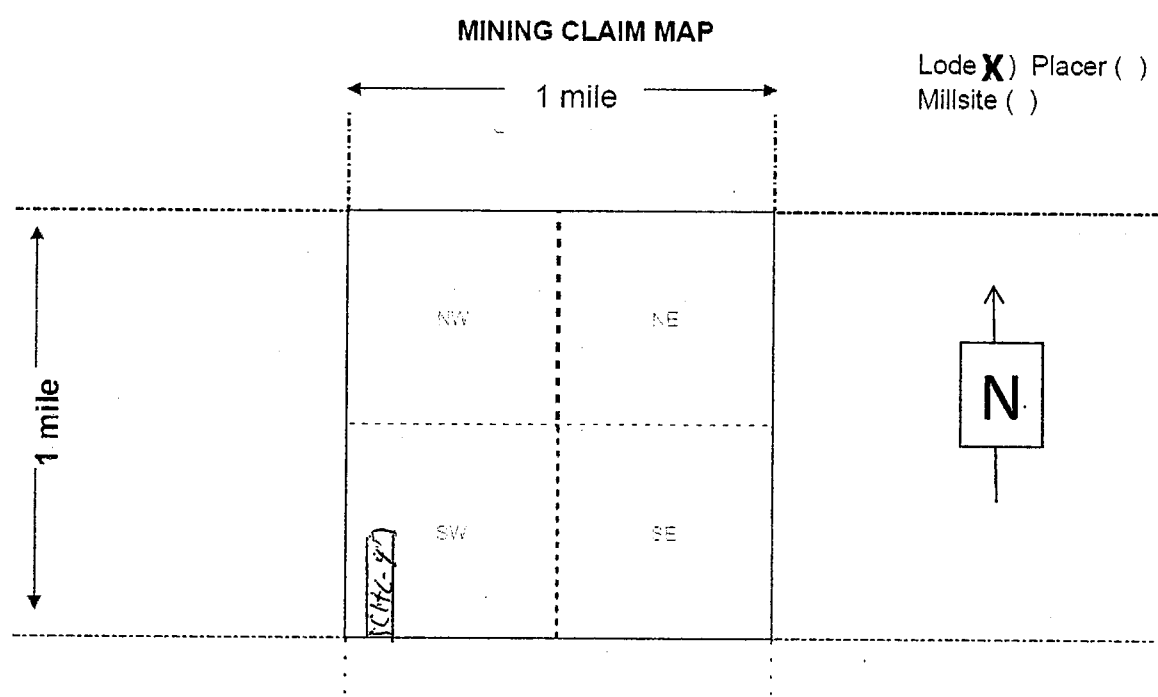

AMC452648

1. The above map depicts the CHL-4 mining claim, which is located in Section 5, Township 23 N, Range 18 W, Gila and Salt River Base and Meridian, Mohave County, Arizona. Total claim acreage is 20.
2. The type of corner and location monuments used are as follows: 2" X 2" X 4' wooden posts
3. The bearings and distances in degrees and feet between this location monument to a public land survey monument is 1,664 feet N 13° E from the SW corner of Sec. 5, T. 23 N., R. 18 W., GSRBM. as depicted on the map.

FEE# 2018059303

OFFICIAL RECORDS  
OF MOHAVE COUNTY  
KRISTI BLAIR,  
COUNTY RECORDER



11/30/2018 03:26 PM Fee: \$10.00

PAGE: 1 of 2

2

LOCATION NOTICE FOR LODE MINING CLAIM

Amendment BLM Serial # \_\_\_\_\_

NOTICE IS HEREBY GIVEN that the CHL - 5 lode mining claim has been located by Amazona Enterprises whose current mailing address is

1846 E. Innovation Park Dr. STE 100  
Oro Valley, AZ 85755.

The general course of this claim is north-south and it is situated in Mohave County, Arizona. This claim is 1500 feet in length and 600 feet in width.

20 Total Claim Acreage.

This claim runs from the location monument on which this location notice is posted on the centerline of the claim approximately 100 feet in a south direction to the south end line and 300 feet in a west direction to the west end line and 1500 feet north to the north end line and 600 feet east to the east end line and 1500 feet south to the south end line. This claim is marked by six monuments, one at each corner and one at the center of each end line of the claim.

The location monument on which this notice is posted is situated within Section 5 in Township 23 North, Range 18 W, Gila Salt River Base and Meridian (GSRBM), Arizona and this claim encompasses portions of the following quarter section(s), section(s), Township(s) and Range(s) SW 1/4 of Section 5 in Township 23 N, R 18 W of the GSRBM, Arizona.

The locality of this claim with reference to some natural object or permanent monument and additional information (if any) concerning its locality are as follows:  
1,502 feet N 86° E from the SW corner of Section 5 in T 23 N and R 18 W of the GSRBM.

The above information is shown on the attached map.

DATED AND POSTED on the ground this 12 day of September, 2018.

LOCATOR(s)  AGENT

Print Name(s) William Feyerabend

Signature(s) William Feyerabend

RECEIVED  
BLM AZ STATE OFFICE  
2018 DEC -3 P 3:06  
PHOENIX, ARIZONA

AMC452649

RECEIVED  
BLM AZ STATE OFFICE  
2010 DEC - 3 P 3:06  
PHOENIX, ARIZONA

### MINING CLAIM MAP

Lode ( )

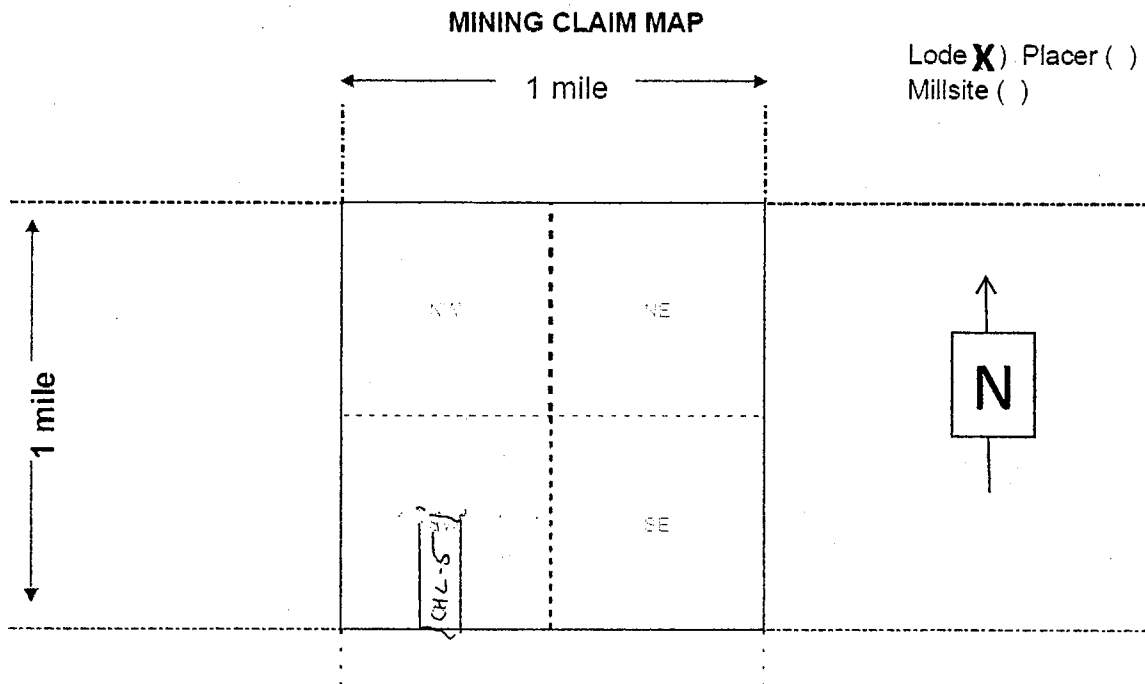

AMC452649

1. The above map depicts the CHL-5 mining claim, which is located in Section 5, Township 23 N, Range 18 W, Gila and Salt River Base and Meridian, Mohave County, Arizona. Total claim acreage is 20.
2. The type of corner and location monuments used are as follows: 2" X 2" X 4' wooden posts
3. The bearings and distances in degrees and feet between this location monument to a public land survey monument is 1,502 feet N 86° E from the SW corner of Sec. 5, T. 23 N., R. 18 W., GSRBM, as depicted on the map.



FEE# 2018059304

OFFICIAL RECORDS  
OF MOHAVE COUNTY  
KRISTI BLAIR,  
COUNTY RECORDER



11/30/2018 03:26 PM Fee: \$10.00

PAGE: 1 of 2

2

**LOCATION NOTICE FOR LODE MINING CLAIM**

Amendment BLM Serial # \_\_\_\_\_

NOTICE IS HEREBY GIVEN that the CHL - 6 lode mining claim has been located by Amazona Enterprises whose current mailing address is

1846 E. Innovation Park Dr. STE 100  
Oro Valley, AZ 85755.

The general course of this claim is north-south and it is situated in Mohave County, Arizona. This claim is 1500 feet in length and 600 feet in width.

20 Total Claim Acreage.

RECEIVED  
BLM AZ STATE OFFICE  
2018 DEC - 3 P 3:06  
PHOENIX, ARIZONA

This claim runs from the location monument on which this location notice is posted on the centerline of the claim approximately 100 feet in a south direction to the south end line and 300 feet in a west direction to the west end line and 1500 feet north to the north end line and 600 feet east to the east end line and 1500 feet south to the south end line. This claim is marked by six monuments, one at each corner and one at the center of each end line of the claim.

The location monument on which this notice is posted is situated within Section 5 in Township 23 North, Range 18 W, Gila Salt River Base and Meridian (GSRBM), Arizona and this claim encompasses portions of the following quarter section(s), section(s), Township(s) and Range(s) SW ¼ of Section 5 in Township 23 N, R 18 W of the GSRBM, Arizona.

The locality of this claim with reference to some natural object or permanent monument and additional information (if any) concerning its locality are as follows:  
2,102 feet N 87° E from the SW corner of Section 5 in T 23 N and R 18 W of the GSRBM.

The above information is shown on the attached map.

DATED AND POSTED on the ground this 12 day of September, 2018.

LOCATOR(s)  AGENT

Print Name(s) William Feyerabend  
Signature(s) William Feyerabend

AMC452650

RECEIVED  
BLM AZ STATE OFFICE  
2018 DEC -3 P 3:06  
PHOENIX, ARIZONA

**MINING CLAIM MAP**

Lode ( )

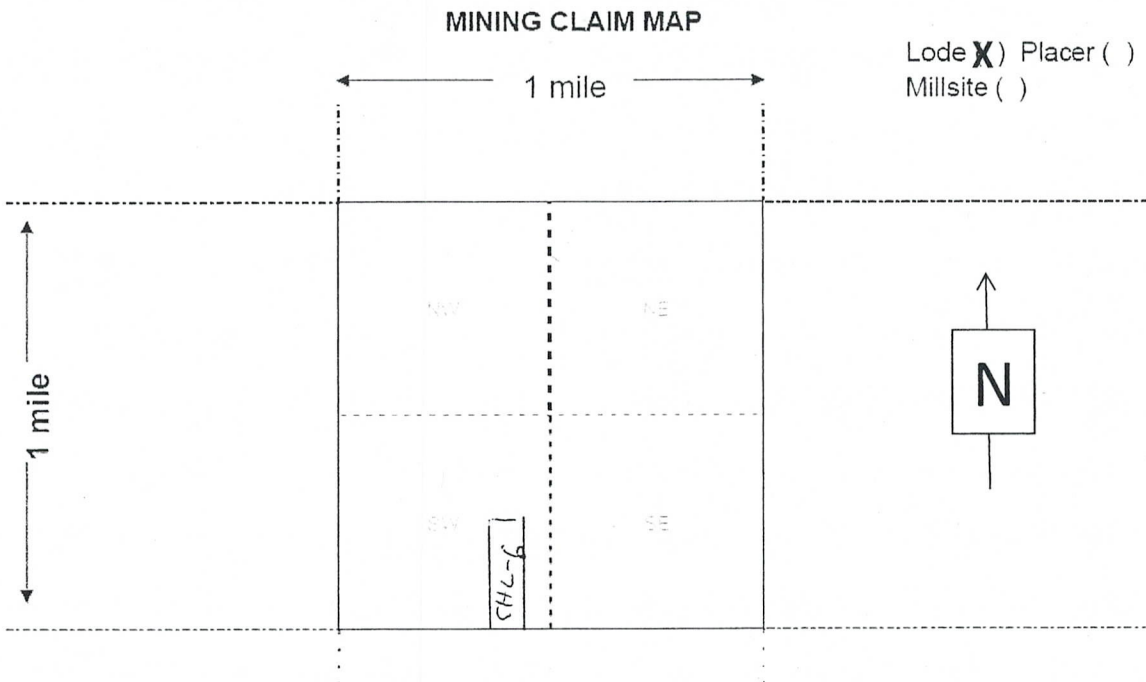

AMC452650

1. The above map depicts the CHL-6 mining claim, which is located in Section 5, Township 23 N, Range 18 W, Gila and Salt River Base and Meridian, Mohave County, Arizona. Total claim acreage is 20.
2. The type of corner and location monuments used are as follows: 2" X 2" X 4' wooden posts
3. The bearings and distances in degrees and feet between this location monument to a public land survey monument is 2,102 feet N 87° E from the SW corner of Sec. 5, T. 23 N., R. 18 W., GSRBM. as depicted on the map.



FEE# 2018059305

OFFICIAL RECORDS  
OF MOHAVE COUNTY  
KRISTI BLAIR,  
COUNTY RECORDER



11/30/2018 03:26 PM Fee: \$10.00

PAGE: 1 of 2

2

**LOCATION NOTICE FOR LODE MINING CLAIM**

Amendment BLM Serial # \_\_\_\_\_

NOTICE IS HEREBY GIVEN that the CHL - 7 lode mining claim has been located by Amazona Enterprises whose current mailing address is

1846 E. Innovation Park Dr. STE 100  
Oro Valley, AZ 85755.

The general course of this claim is north-south and it is situated in Mohave County, Arizona. This claim is 1500 feet in length and 600 feet in width.

20 Total Claim Acreage.

RECEIVED  
BLM AZ STATE OFFICE  
2018 DEC -3 P 3:06  
PHOENIX, ARIZONA

This claim runs from the location monument on which this location notice is posted on the centerline of the claim approximately 100 feet in a south direction to the south end line and 300 feet in a west direction to the west end line and 1500 feet north to the north end line and 600 feet east to the east end line and 1500 feet south to the south end line. This claim is marked by six monuments, one at each corner and one at the center of each end line of the claim.

The location monument on which this notice is posted is situated within Section 5 in Township 23 North, Range 18 W, Gila Salt River Base and Meridian (GSRBM), Arizona and this claim encompasses portions of the following quarter section(s), section(s), Township(s) and Range(s) SW and SE ¼ of Section 5 in Township 23 N, R 18 W of the GSRBM, Arizona.

The locality of this claim with reference to some natural object or permanent monument and additional information (if any) concerning its locality are as follows:  
2,702 feet N 88° E from the SW corner of Section 5 in T 23 N and R 18 W of the GSRBM.

The above information is shown on the attached map.

DATED AND POSTED on the ground this 12 day of September, 2018.

LOCATOR(s)  AGENT

Print Name(s) William Feyerabend  
Signature(s) William Feyerabend

AMC452651



RECEIVED  
BLM AZ STATE OFFICE  
2010 DEC -3 P 3:06  
PHOENIX, ARIZONA

**MINING CLAIM MAP**  
Lode ( )

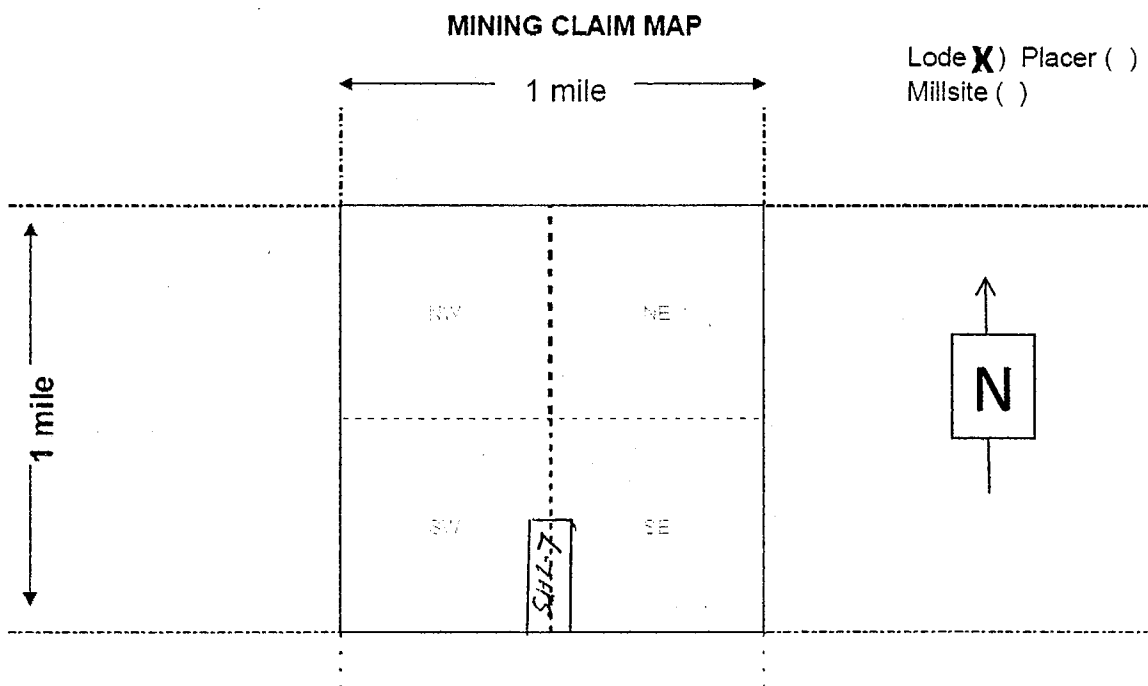

AMC 452651

1. The above map depicts the CHL-7 mining claim, which is located in Section 5, Township 23 N , Range 18 W, Gila and Salt River Base and Meridian, Mohave County, Arizona. Total claim acreage is 20.
2. The type of corner and location monuments used are as follows: 2" X 2" X 4' wooden posts
3. The bearings and distances in degrees and feet between this location monument to a public land survey monument is 2,702 feet N 88° E from the SW corner of Sec. 5, T. 23 N., R. 18 W., GSRBM. as depicted on the map.

FEE# 2018059306

OFFICIAL RECORDS  
OF MOHAVE COUNTY  
KRISTI BLAIR,  
COUNTY RECORDER



11/30/2018 03:26 PM Fee: \$10.00

PAGE: 1 of 2

2

**LOCATION NOTICE FOR LODE MINING CLAIM**

Amendment BLM Serial # \_\_\_\_\_

NOTICE IS HEREBY GIVEN that the CHL - 8 lode mining claim has been located by Amazona Enterprises whose current mailing address is

1846 E. Innovation Park Dr. STE 100  
Oro Valley, AZ 85755.

The general course of this claim is north-south and it is situated in Mohave County, Arizona. This claim is 1500 feet in length and 600 feet in width.

20 Total Claim Acreage.

This claim runs from the location monument on which this location notice is posted on the centerline of the claim approximately 100 feet in a south direction to the south end line and 300 feet in a west direction to the west end line and 1500 feet north to the north end line and 600 feet east to the east end line and 1500 feet south to the south end line. This claim is marked by six monuments, one at each corner and one at the center of each end line of the claim.

The location monument on which this notice is posted is situated within Section 8 in Township 23 North, Range 18 W, Gila Salt River Base and Meridian (GSRBM), Arizona and this claim encompasses portions of the following quarter section(s), section(s), Township(s) and Range(s) NW ¼ of Section 8 in Township 23 N, R 18 W of the GSRBM, Arizona.

The locality of this claim with reference to some natural object or permanent monument and additional information (if any) concerning its locality are as follows:  
1,432 feet S 12° E from the NW corner of Section 8 in T 23 N, R 18 W of the GSRBM.

The above information is shown on the attached map.

DATED AND POSTED on the ground this 12 day of September, 2018.

LOCATOR(s)  AGENT

Print Name(s) William Feyerabend

Signature(s) William Feyerabend

RECEIVED  
BLM AZ STATE OFFICE  
2018 DEC -3 P 3:06  
PHOENIX, ARIZONA

AMC452652

RECEIVED  
BLM AZ STATE OFFICE  
2010 DEC - 3 P 3:06  
PHOENIX, ARIZONA

**MINING CLAIM MAP**  
Lode ( )

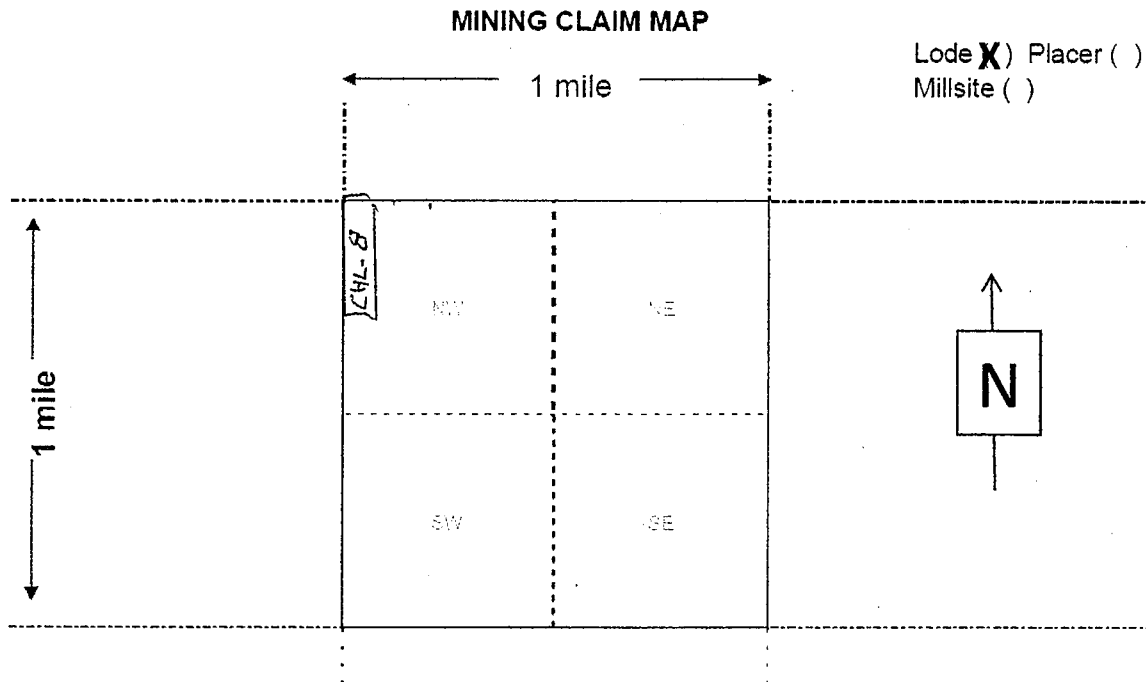

AMC452652

1. The above map depicts the CHL-8 mining claim, which is located in Section 8, Township 23 N , Range 18 W, Gila and Salt River Base and Meridian, Mohave County, Arizona. Total claim acreage is 20.
2. The type of corner and location monuments used are as follows: 2" X 2" X 4' wooden posts
3. The bearings and distances in degrees and feet between this location monument to a public land survey monument is 1,432 feet S 12° E from the NW corner of Sec. 8, T. 23 N., R. 18 W., GSRBM. as depicted on the map.



FEE# 2018059307

OFFICIAL RECORDS  
OF MOHAVE COUNTY  
KRISTI BLAIR,  
COUNTY RECORDER



11/30/2018 03:26 PM Fee: \$10.00

PAGE: 1 of 2

2

**LOCATION NOTICE FOR LODE MINING CLAIM**

Amendment BLM Serial # \_\_\_\_\_

NOTICE IS HEREBY GIVEN that the CHL - 9 lode mining claim has been located by Amazona Enterprises whose current mailing address is

1846 E. Innovation Park Dr. STE 100  
Oro Valley, AZ 85755.

The general course of this claim is north-south and it is situated in Mohave County, Arizona. This claim is 1500 feet in length and 600 feet in width.  
20 Total Claim Acreage.

This claim runs from the location monument on which this location notice is posted on the centerline of the claim approximately 100 feet in a south direction to the south end line and 300 feet in a west direction to the west end line and 1500 feet north to the north end line and 600 feet east to the east end line and 1500 feet south to the south end line. This claim is marked by six monuments, one at each corner and one at the center of each end line of the claim.

The location monument on which this notice is posted is situated within Section 8 in Township 23 North, Range 18 W, Gila Salt River Base and Meridian (GSRBM), Arizona and this claim encompasses portions of the following quarter section(s), section(s), Township(s) and Range(s) NW ¼ of Section 8 in Township 23 N, R 18 W of the GSRBM, Arizona.

The locality of this claim with reference to some natural object or permanent monument and additional information (if any) concerning its locality are as follows:  
1,664 feet S 33° E from the NW corner of Section 8 in T 23 N, R 18 W of the GSRBM.

The above information is shown on the attached map.

DATED AND POSTED on the ground this 12 day of September, 2018.

LOCATOR(S)  AGENT

Print Name(s) William Feyerabend  
Signature(s) William Feyerabend

RECEIVED  
BLM AZ STATE OFFICE  
2018 DEC - 3 P 3:05  
PHOENIX, ARIZONA

AMC452653

RECEIVED  
BLM AZ STATE OFFICE  
2018 DEC - 3 P 3:01  
PHOENIX, ARIZONA

**MINING CLAIM MAP**

Lode ( )

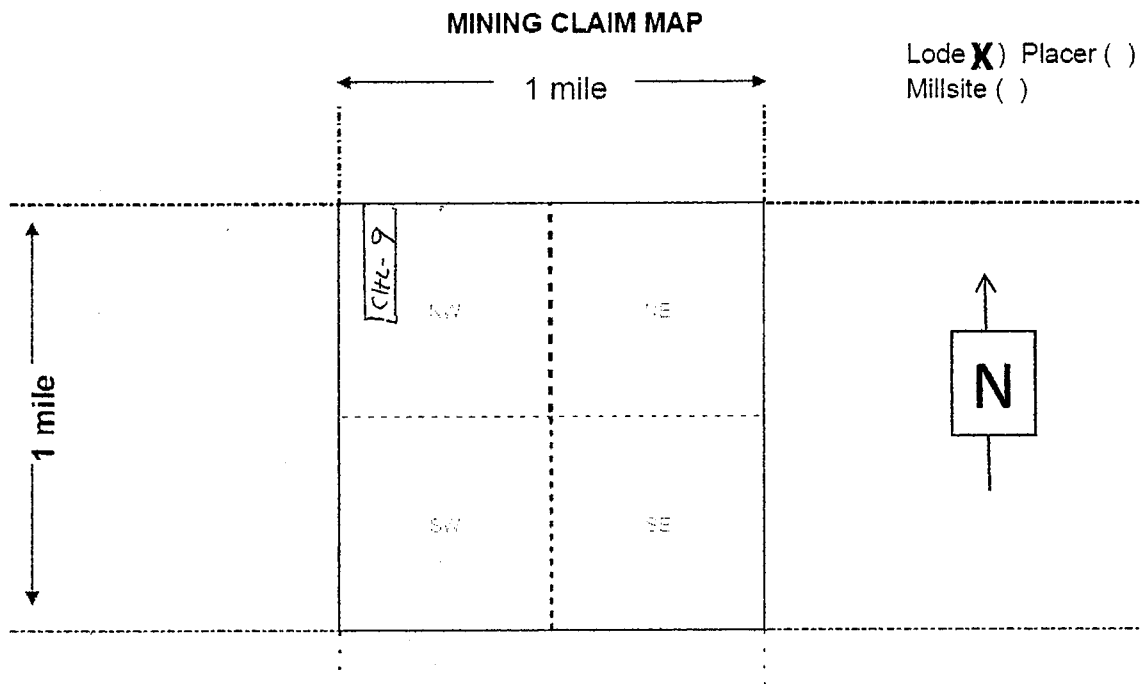

AM0452653

1. The above map depicts the CHL-9 mining claim, which is located in Section 8, Township 23 N, Range 18 W, Gila and Salt River Base and Meridian, Mohave County, Arizona. Total claim acreage is 20.
2. The type of corner and location monuments used are as follows: 2" X 2" X 4' wooden posts
3. The bearings and distances in degrees and feet between this location monument to a public land survey monument is 1,664 feet S 33° E from the NW corner of Sec. 8, T. 23 N., R. 18 W., GSRBM. as depicted on the map.



FEE# 2018059308

OFFICIAL RECORDS  
OF MOHAVE COUNTY  
KRISTI BLAIR,  
COUNTY RECORDER



11/30/2018 03:26 PM Fee: \$10.00

PAGE: 1 of 2

2

**LOCATION NOTICE FOR LODE MINING CLAIM**

Amendment BLM Serial # \_\_\_\_\_

NOTICE IS HEREBY GIVEN that the CHL - 10 lode mining claim has been located by Amazona Enterprises whose current mailing address is

1846 E. Innovation Park Dr. STE 100  
Oro Valley, AZ 85755.

The general course of this claim is north-south and it is situated in Mohave County, Arizona. This claim is 1500 feet in length and 600 feet in width.  
20 Total Claim Acreage.

RECEIVED  
BLM AZ STATE OFFICE  
2018 DEC - 3 P 3:07  
PHOENIX, ARIZONA

This claim runs from the location monument on which this location notice is posted on the centerline of the claim approximately 100 feet in a south direction to the south end line and 300 feet in a west direction to the west end line and 1500 feet north to the north end line and 600 feet east to the east end line and 1500 feet south to the south end line. This claim is marked by six monuments, one at each corner and one at the center of each end line of the claim.

The location monument on which this notice is posted is situated within Section 8 in Township 23 North, Range 18 W, Gila Salt River Base and Meridian (GSRBM), Arizona and this claim encompasses portions of the following quarter section(s), section(s), Township(s) and Range(s) NW 1/4 of Section 8 in Township 23 N, R 18 W of the GSRBM, Arizona.

The locality of this claim with reference to some natural object or permanent monument and additional information (if any) concerning its locality are as follows:  
2,052 feet S 47° E from the NW corner of Section 8 in T 23 N, R 18 W of the GSRBM.

The above information is shown on the attached map.

DATED AND POSTED on the ground this 11 day of September, 2018.

LOCATOR(S)  AGENT

Print Name(s) William Feyerabend  
Signature(s) William Feyerabend

AMC452654



RECEIVED  
BLM AZ STATE OFFICE  
2010 DEC - 3 P 3: 07  
PHOENIX, ARIZONA

**MINING CLAIM MAP**

Lode ( )

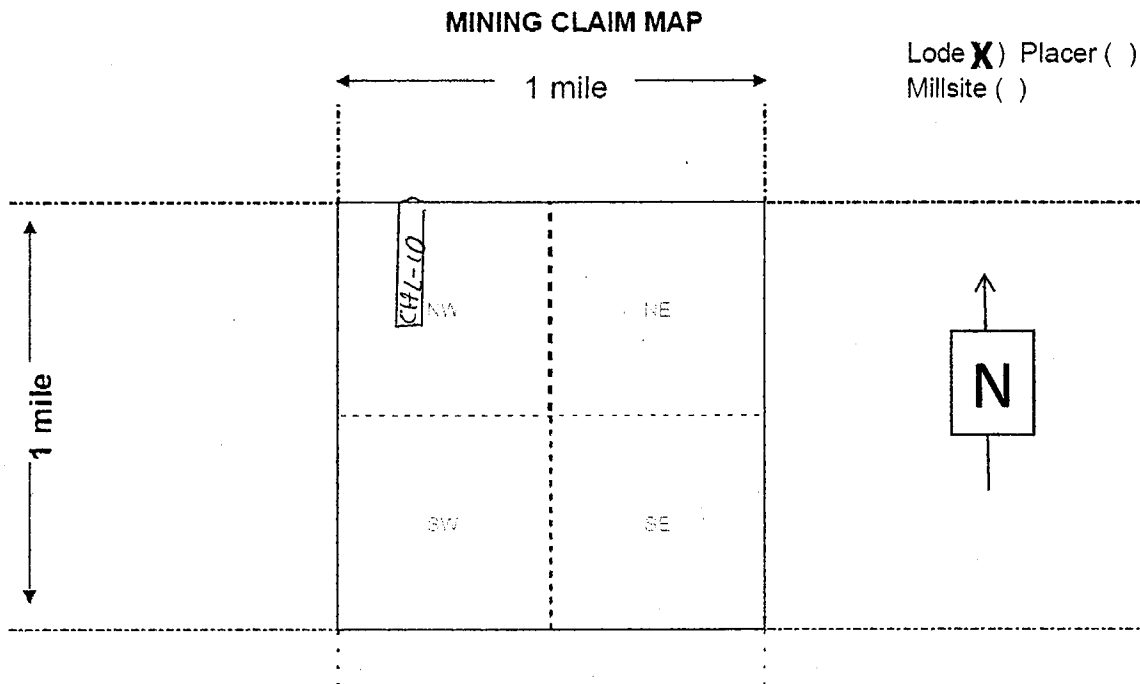

AMC452654

1. The above map depicts the CHL-10 mining claim, which is located in Section 8, Township 23 N, Range 18 W, Gila and Salt River Base and Meridian, Mohave County, Arizona. Total claim acreage is 20.
2. The type of corner and location monuments used are as follows: 2" X 2" X 4' wooden posts
3. The bearings and distances in degrees and feet between this location monument to a public land survey monument is 2,052 feet S 47° E from the NW corner of Sec. 8, T. 23 N., R. 18 W., GSRBM. as depicted on the map.

FEE# 2018059309

OFFICIAL RECORDS  
OF MOHAVE COUNTY  
KRISTI BLAIR,  
COUNTY RECORDER



11/30/2018 03:26 PM Fee: \$10.00

PAGE: 1 of 2

2

**LOCATION NOTICE FOR LODE MINING CLAIM**

Amendment BLM Serial # \_\_\_\_\_

NOTICE IS HEREBY GIVEN that the CHL - 11 lode mining claim has been located by Amazona Enterprises whose current mailing address is

1846 E. Innovation Park Dr. STE 100  
Oro Valley, AZ 85755.

The general course of this claim is north-south and it is situated in Mohave County, Arizona. This claim is 1500 feet in length and 600 feet in width.  
20 Total Claim Acreage.

RECEIVED  
BLM AZ STATE OFFICE  
2018 DEC - 3 P 3:07  
PHOENIX, ARIZONA

This claim runs from the location monument on which this location notice is posted on the centerline of the claim approximately 100 feet in a south direction to the south end line and 300 feet in a west direction to the west end line and 1500 feet north to the north end line and 600 feet east to the east end line and 1500 feet south to the south end line. This claim is marked by six monuments, one at each corner and one at the center of each end line of the claim.

The location monument on which this notice is posted is situated within Section 8 in Township 23 North, Range 18 W, Gila Salt River Base and Meridian (GSRBM), Arizona and this claim encompasses portions of the following quarter section(s), section(s), Township(s) and Range(s) NW ¼ of Section 8 in Township 23 N, R 18 W of the GSRBM, Arizona.

The locality of this claim with reference to some natural object or permanent monument and additional information (if any) concerning its locality are as follows:  
2,524 feet S 56° E from the NW corner of Section 8 in T 23 N, R 18 W of the GSRBM.

The above information is shown on the attached map.

DATED AND POSTED on the ground this 11 day of September, 2018.

LOCATOR(S)  AGENT

Print Name(s) William Feyerabend  
Signature(s) William Feyerabend

AMC452655

RECEIVED  
 BLM AZ STATE OFFICE  
 2010 DEC - 3 P 3:07  
 PHOENIX, ARIZONA

**MINING CLAIM MAP**

Lode ( )

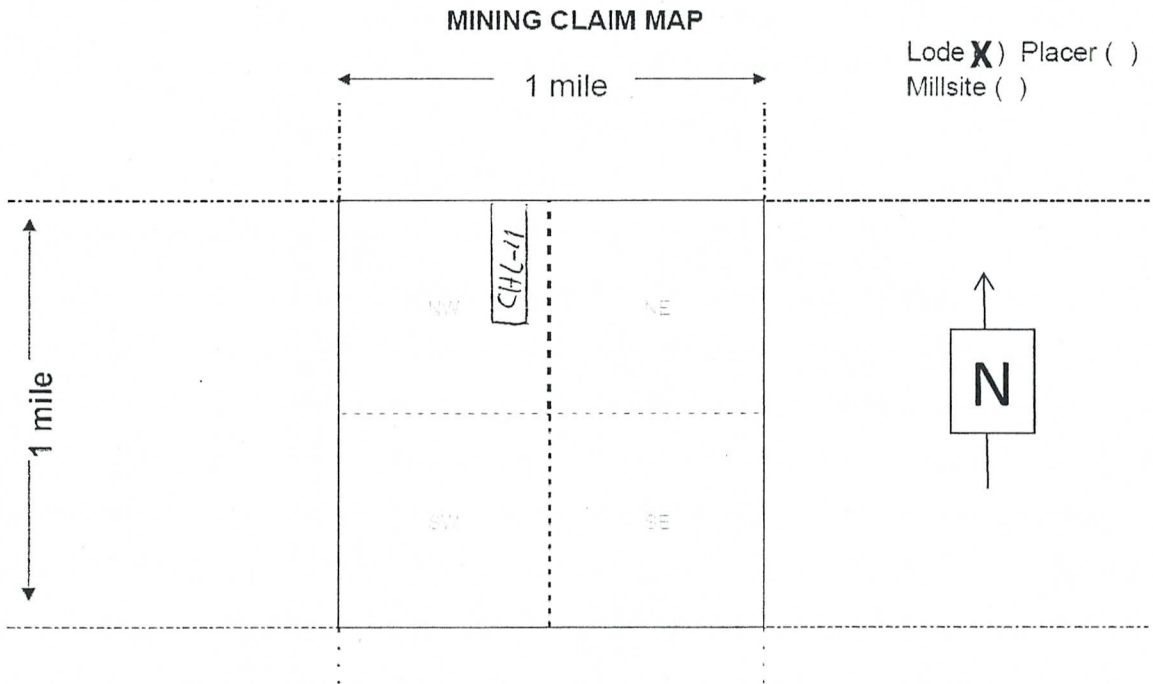

AMC452655

1. The above map depicts the CHL-11 mining claim, which is located in Section 8, Township 23 N, Range 18 W, Gila and Salt River Base and Meridian, Mohave County, Arizona. Total claim acreage is 20.
2. The type of corner and location monuments used are as follows: 2" X 2" X 4' wooden posts
3. The bearings and distances in degrees and feet between this location monument to a public land survey monument is 2,524 feet S 56° E from the NW corner of Sec. 8, T. 23 N., R. 18 W., GSRBM. as depicted on the map.



FEE# 2018059310

OFFICIAL RECORDS  
OF MOHAVE COUNTY  
KRISTI BLAIR,  
COUNTY RECORDER



11/30/2018 03:26 PM Fee: \$10.00

PAGE: 1 of 2

2

**LOCATION NOTICE FOR LODE MINING CLAIM**

Amendment BLM Serial # \_\_\_\_\_

NOTICE IS HEREBY GIVEN that the CHL - 12 lode mining claim has been located by Amazona Enterprises whose current mailing address is

1846 E. Innovation Park Dr. STE 100  
Oro Valley, AZ 85755.

The general course of this claim is north-south and it is situated in Mohave County, Arizona. This claim is 1500 feet in length and 600 feet in width.

20 Total Claim Acreage.

RECEIVED  
BLM AZ STATE OFFICE  
2018 DEC - 3 P 3: 07  
PHOENIX, ARIZONA

This claim runs from the location monument on which this location notice is posted on the centerline of the claim approximately 100 feet in a south direction to the south end line and 300 feet in a west direction to the west end line and 1500 feet north to the north end line and 600 feet east to the east end line and 1500 feet south to the south end line. This claim is marked by six monuments, one at each corner and one at the center of each end line of the claim.

The location monument on which this notice is posted is situated within Section 8 in Township 23 North, Range 18 W, Gila Salt River Base and Meridian (GSRBM), Arizona and this claim encompasses portions of the following quarter section(s), section(s), Township(s) and Range(s) NW and NE ¼ of Section 8 in Township 23 N, R 18 W of the GSRBM, Arizona.

The locality of this claim with reference to some natural object or permanent monument and additional information (if any) concerning its locality are as follows:  
3,042 feet S 62° E from the NW corner of Section 8 in T 23 N, R 18 W of the GSRBM.

The above information is shown on the attached map.

DATED AND POSTED on the ground this 11 day of September, 2018.

LOCATOR(s)  AGENT

Print Name(s) William Feyerabend  
Signature(s) William Feyerabend

AMC452656

RECEIVED  
BLM AZ STATE OFFICE  
2010 DEC -3 P 3:07  
PHOENIX, ARIZONA

### MINING CLAIM MAP

Lode ( )

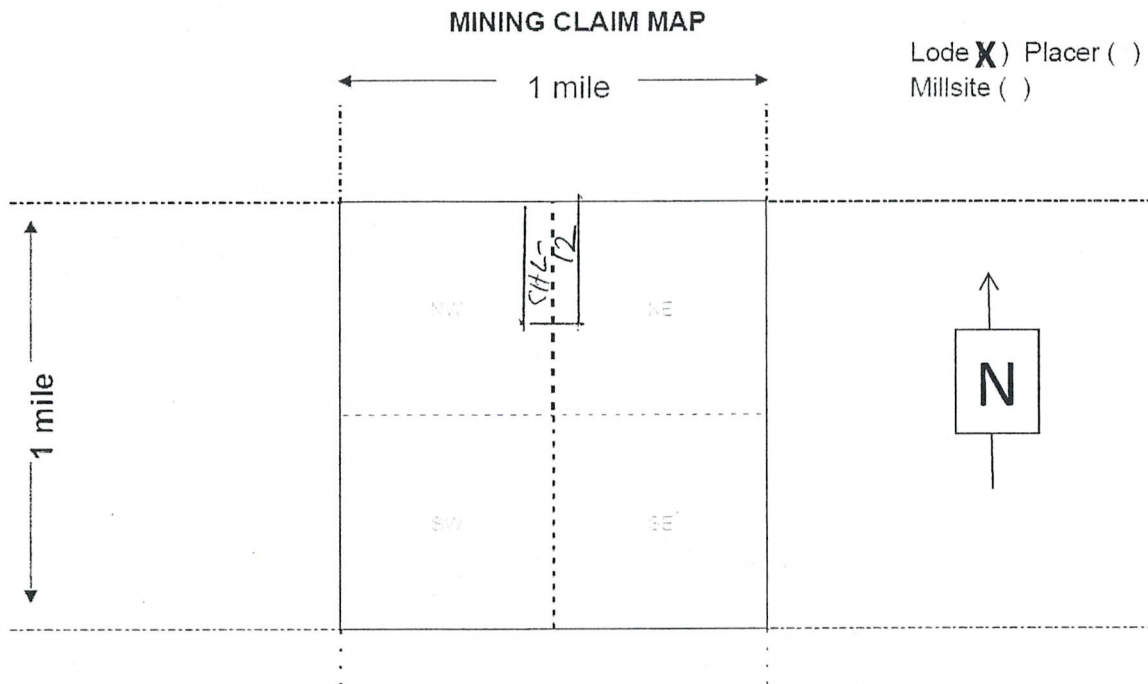

AMC452656

1. The above map depicts the CHL-12 mining claim, which is located in Section 8, Township 23 N , Range 18 W, Gila and Salt River Base and Meridian, Mohave County, Arizona. Total claim acreage is 20.
2. The type of corner and location monuments used are as follows: 2" X 2" X 4' wooden posts
3. The bearings and distances in degrees and feet between this location monument to a public land survey monument is 3,042 feet S 62° E from the NW corner of Sec. 8, T. 23 N., R. 18 W., GSRBM. as depicted on the map.



FEE# 2018059311

OFFICIAL RECORDS  
OF MOHAVE COUNTY  
KRISTI BLAIR,  
COUNTY RECORDER



11/30/2018 03:26 PM Fee: \$10.00

PAGE: 1 of 2

2

LOCATION NOTICE FOR LODE MINING CLAIM

Amendment BLM Serial # \_\_\_\_\_

NOTICE IS HEREBY GIVEN that the CHL - 13 lode mining claim has been located by Amazona Enterprises whose current mailing address is

1846 E. Innovation Park Dr. STE 100  
Oro Valley, AZ 85755.

The general course of this claim is north-south and it is situated in Mohave County, Arizona. This claim is 1500 feet in length and 600 feet in width.

20 Total Claim Acreage.

This claim runs from the location monument on which this location notice is posted on the centerline of the claim approximately 100 feet in a south direction to the south end line and 300 feet in a west direction to the west end line and 1500 feet north to the north end line and 600 feet east to the east end line and 1500 feet south to the south end line. This claim is marked by six monuments, one at each corner and one at the center of each end line of the claim.

The location monument on which this notice is posted is situated within Section 8 in Township 23 North, Range 18 W, Gila Salt River Base and Meridian (GSRBM), Arizona and this claim encompasses portions of the following quarter section(s), section(s), Township(s) and Range(s) NE 1/4 of Section 8 in Township 23 N, R 18 W of the GSRBM, Arizona.

The locality of this claim with reference to some natural object or permanent monument and additional information (if any) concerning its locality are as follows:  
3,586 feet S 67° E from the NW corner of Section 8 in T 23 N, R 18 W of the GSRBM.

The above information is shown on the attached map.

DATED AND POSTED on the ground this 11 day of September, 2018.

LOCATOR(s)  AGENT

Print Name(s) William Feyerabend

Signature(s) William Feyerabend

RECEIVED  
BLM AZ STATE OFFICE  
2018 DEC -3 P 3:07  
PHOENIX, ARIZONA

AMC452657

RECEIVED  
BLM AZ STATE OFFICE  
2010 DEC - 3 P 3:07  
PHOENIX, ARIZONA

**MINING CLAIM MAP**

Lode ( )

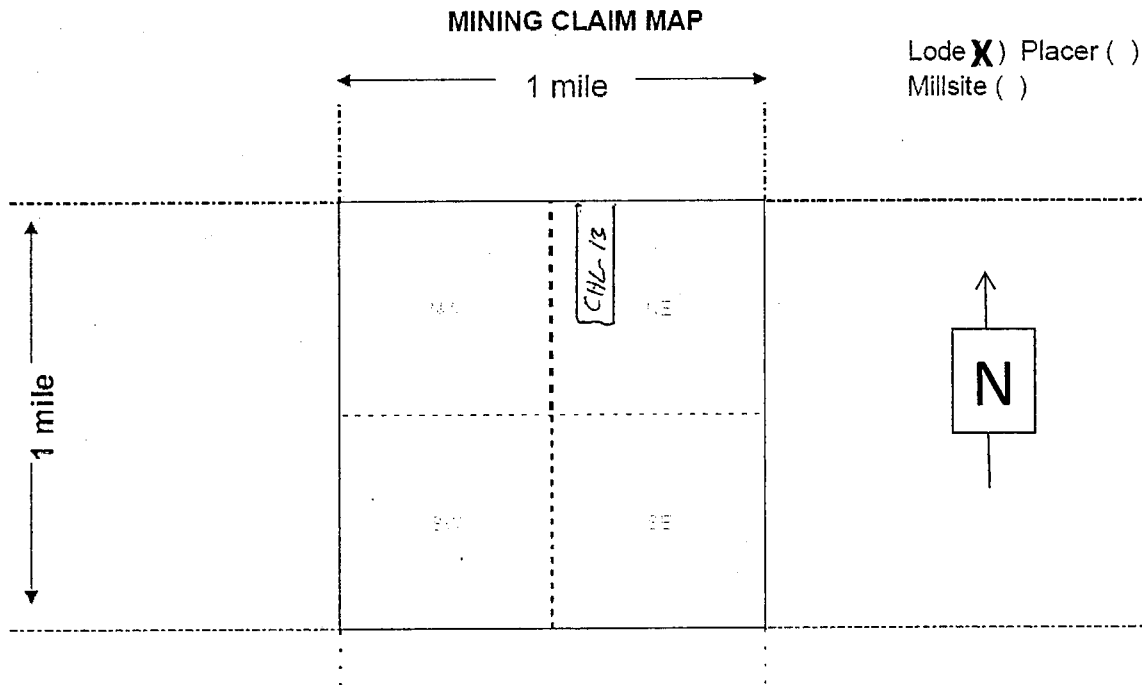

AMC4526571

1. The above map depicts the CHL-13 mining claim, which is located in Section 8, Township 23 N., Range 18 W, Gila and Salt River Base and Meridian, Mohave County, Arizona. Total claim acreage is 20.
2. The type of corner and location monuments used are as follows: 2" X 2" X 4' wooden posts
3. The bearings and distances in degrees and feet between this location monument to a public land survey monument is 3,586 feet S 67° E from the NW corner of Sec. 8, T. 23 N., R. 18 W., GSRBM. as depicted on the map.



FEE# 2018059312

OFFICIAL RECORDS  
OF MOHAVE COUNTY  
KRISTI BLAIR,  
COUNTY RECORDER



11/30/2018 03:26 PM Fee: \$10.00

PAGE: 1 of 2

2

LOCATION NOTICE FOR LODE MINING CLAIM

Amendment BLM Serial # \_\_\_\_\_

NOTICE IS HEREBY GIVEN that the CHL - 14 lode mining claim has been located by Amazona Enterprises whose current mailing address is 1846 E. Innovation Park Dr. STE 100 Oro Valley, AZ 85755. The general course of this claim is north-south and it is situated in Mohave County, Arizona. This claim is 1500 feet in length and 600 feet in width. 20 Total Claim Acreage.

RECEIVED  
BLM AZ STATE OFFICE  
2018 DEC -3 P 3:07  
PHOENIX, ARIZONA

This claim runs from the location monument on which this location notice is posted on the centerline of the claim approximately 100 feet in a south direction to the south end line and 300 feet in a west direction to the west end line and 1500 feet north to the north end line and 600 feet east to the east end line and 1500 feet south to the south end line. This claim is marked by six monuments, one at each corner and one at the center of each end line of the claim.

The location monument on which this notice is posted is situated within Section 8 in Township 23 North, Range 18 W, Gila Salt River Base and Meridian (GSRBM), Arizona and this claim encompasses portions of the following quarter section(s), section(s), Township(s) and Range(s) NE 1/4 of Section 8 in Township 23 N, R 18 W of the GSRBM, Arizona.

The locality of this claim with reference to some natural object or permanent monument and additional information (if any) concerning its locality are as follows:  
4,145 feet S 70° E from the NW corner of Section 8 in T 23 N, R 18 W of the GSRBM.

The above information is shown on the attached map.

DATED AND POSTED on the ground this 11 day of September, 2018.

LOCATOR(s)  AGENT

Print Name(s) William Feyerabend  
Signature(s) William Feyerabend

AMC452658

RECEIVED  
BLM AZ STATE OFFICE  
2010 DEC -3 P 3:07  
PHOENIX, ARIZONA

### MINING CLAIM MAP

Lode ( )

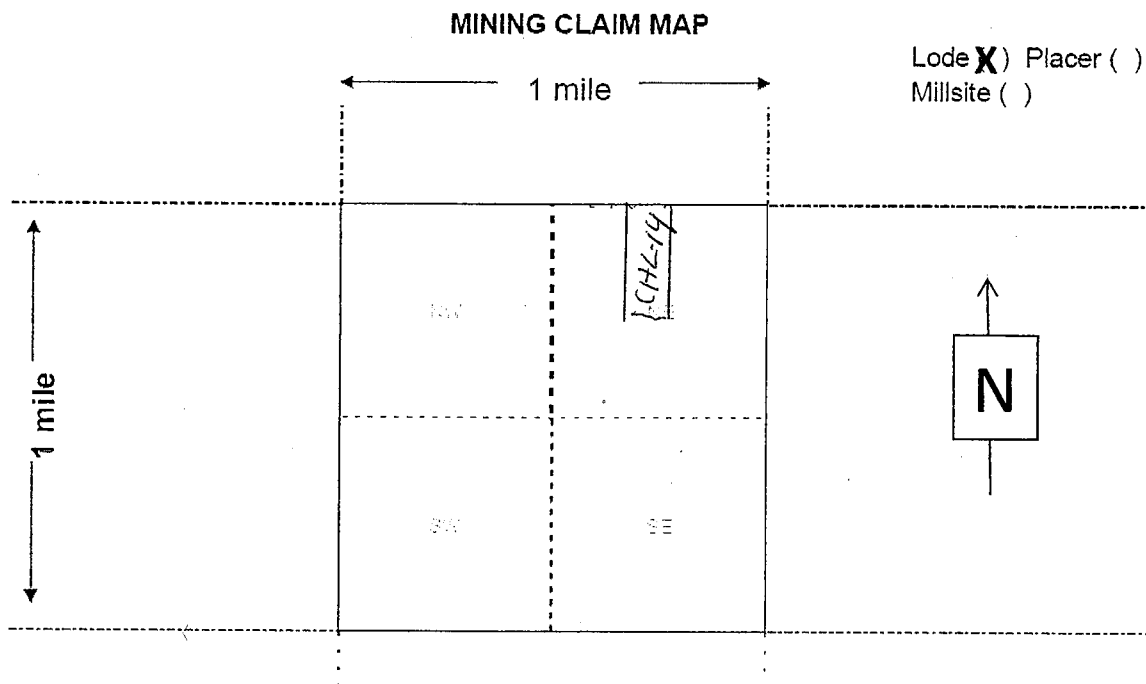

AMC452658

1. The above map depicts the CHL-14 mining claim, which is located in Section 8, Township 23 N, Range 18 W, Gila and Salt River Base and Meridian, Mohave County, Arizona. Total claim acreage is 20.
2. The type of corner and location monuments used are as follows: 2" X 2" X 4' wooden posts
3. The bearings and distances in degrees and feet between this location monument to a public land survey monument is 4,145 feet S 70° E from the NW corner of Sec. 8, T. 23 N., R. 18 W., GSRBM. as depicted on the map.

FEE# 2018059313

OFFICIAL RECORDS  
OF MOHAVE COUNTY  
KRISTI BLAIR  
COUNTY RECORDER



11/30/2018 03:26 PM Fee: \$10.00

PAGE: 1 of 2

2

**LOCATION NOTICE FOR LODE MINING CLAIM**

Amendment BLM Serial # \_\_\_\_\_

NOTICE IS HEREBY GIVEN that the CHL - 15 lode mining claim has been located by Amazona Enterprises whose current mailing address is

1846 E. Innovation Park Dr. STE 100  
Oro Valley, AZ 85755.

The general course of this claim is north-south and it is situated in Mohave County, Arizona. This claim is 1500 feet in length and 600 feet in width.  
20 Total Claim Acreage.

This claim runs from the location monument on which this location notice is posted on the centerline of the claim approximately 100 feet in a north direction to the north end line and 300 feet in a west direction to the west end line and 1500 feet south to the south end line and 600 feet east to the east end line and 1500 feet north to the north end line. This claim is marked by six monuments, one at each corner and one at the center of each end line of the claim.

The location monument on which this notice is posted is situated within Section 8 in Township 23 North, Range 18 W, Gila Salt River Base and Meridian (GSRBM), Arizona and this claim encompasses portions of the following quarter section(s), section(s), Township(s) and Range(s) NW and SW¼ of Section 8 in Township 23 N, R 18 W of the GSRBM, Arizona.

The locality of this claim with reference to some natural object or permanent monument and additional information (if any) concerning its locality are as follows:  
1,625 feet S 11° E from the NW corner of Section 8 in T 23 N, R 18 W of the GSRBM.

The above information is shown on the attached map.

DATED AND POSTED on the ground this 11 day of September, 2018.

LOCATOR(s)  AGENT

Print Name(s) William Feyeraheyd  
Signature(s) William Feyeraheyd

RECEIVED  
BLM AZ STATE OFFICE  
2018 DEC -3 P 3:08  
PHOENIX, ARIZONA

AMC452659

RECEIVED  
 BLM AZ STATE OFFICE  
 2018 DEC - 3 P 3:08  
 PHOENIX, ARIZONA

**MINING CLAIM MAP**  
 Lode ( )

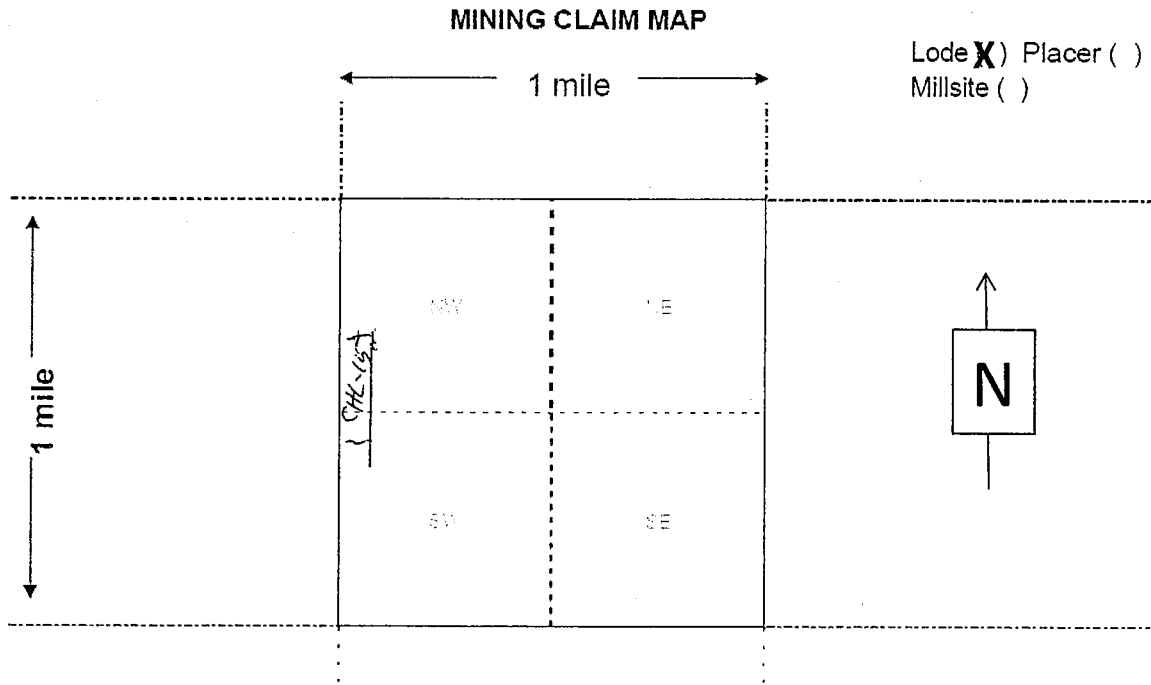

AMC452659

1. The above map depicts the CHL-15 mining claim, which is located in Section 8, Township 23 N , Range 18 W, Gila and Salt River Base and Meridian, Mohave County, Arizona. Total claim acreage is 20.
2. The type of corner and location monuments used are as follows: 2" X 2" X 4' wooden posts
3. The bearings and distances in degrees and feet between this location monument to a public land survey monument is 1,625 feet S 11° E from the NW corner of Sec. 8, T. 23 N., R. 18 W., GSRBM. as depicted on the map.



FEE# 2018059314

OFFICIAL RECORDS  
OF MOHAVE COUNTY  
KRISTI BLAIR,  
COUNTY RECORDER



11/30/2018 03:26 PM Fee: \$10.00

PAGE: 1 of 2

2

**LOCATION NOTICE FOR LODE MINING CLAIM**

Amendment BLM Serial # \_\_\_\_\_

NOTICE IS HEREBY GIVEN that the CHL - 16 lode mining claim has been located by Amazona Enterprises whose current mailing address is 1846 E. Innovation Park Dr. STE 100 Oro Valley, AZ 85755.

The general course of this claim is north-south and it is situated in Mohave County, Arizona. This claim is 1500 feet in length and 600 feet in width. 20 Total Claim Acreage.

This claim runs from the location monument on which this location notice is posted on the centerline of the claim approximately 100 feet in a north direction to the north end line and 300 feet in a west direction to the west end line and 1500 feet south to the south end line and 600 feet east to the east end line and 1500 feet north to the north end line. This claim is marked by six monuments, one at each corner and one at the center of each end line of the claim.

The location monument on which this notice is posted is situated within Section 8 in Township 23 North, Range 18 W, Gila Salt River Base and Meridian (GSRBM), Arizona and this claim encompasses portions of the following quarter section(s), section(s), Township(s) and Range(s) NW and SW¼ of Section 8 in Township 23 N, R 18 W of the GSRBM, Arizona.

The locality of this claim with reference to some natural object or permanent monument and additional information (if any) concerning its locality are as follows:  
1,833 feet S 30° E from the NW corner of Section 8 in T 23 N, R 18 W of the GSRBM.

The above information is shown on the attached map.

DATED AND POSTED on the ground this 12 day of September, 2018.

LOCATOR(s)  AGENT

Print Name(s) William Feyerabend  
Signature(s) William Feyerabend

RECEIVED  
BLM AZ STATE OFFICE  
2018 DEC -3 P 3:08  
PHOENIX, ARIZONA

AMC452660

RECEIVED  
BLM AZ STATE OFFICE  
2018 DEC - 3 P 3:08  
PHOENIX, ARIZONA

**MINING CLAIM MAP**

Lode ( )

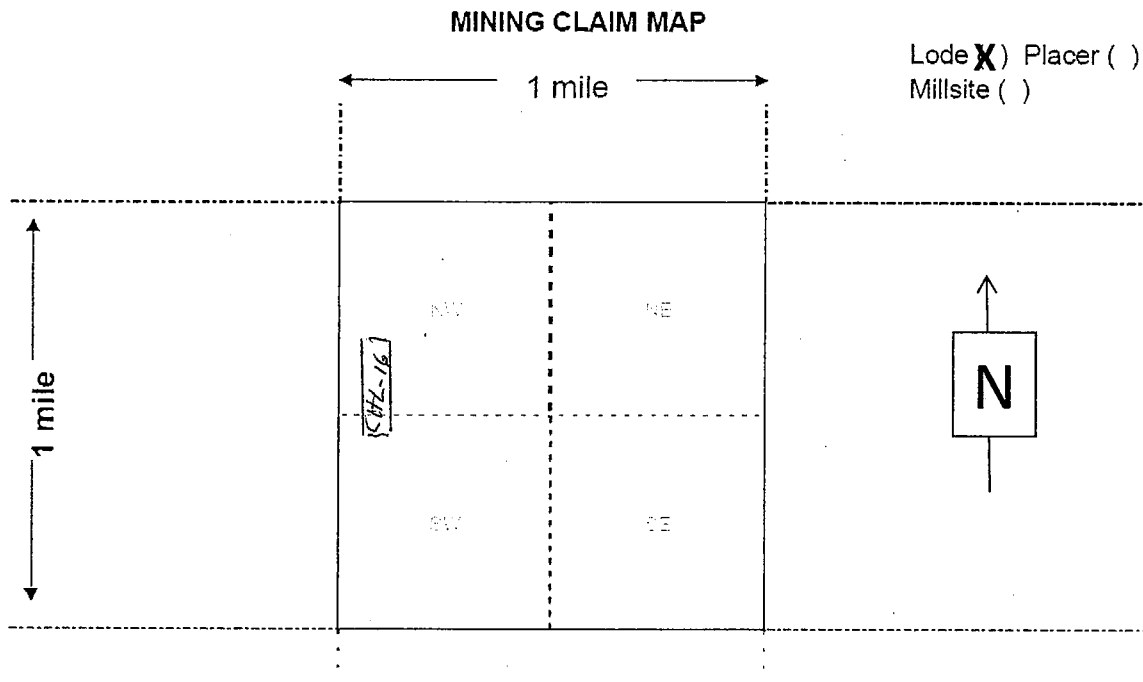

AMC452660

1. The above map depicts the CHL-16 mining claim, which is located in Section 8, Township 23 N, Range 18 W, Gila and Salt River Base and Meridian, Mohave County, Arizona. Total claim acreage is 20.
2. The type of corner and location monuments used are as follows: 2" X 2" X 4' wooden posts
3. The bearings and distances in degrees and feet between this location monument to a public land survey monument is 1,833 feet S 30° E from the NW corner of Sec. 8, T. 23 N., R. 18 W., GSRBM. as depicted on the map.

FEE# 2018059315

OFFICIAL RECORDS  
OF MOHAVE COUNTY  
KRISTI BLAIR,  
COUNTY RECORDER



11/30/2018 03:26 PM Fee: \$10.00

PAGE: 1 of 2

2

**LOCATION NOTICE FOR LODE MINING CLAIM**

Amendment BLM Serial # \_\_\_\_\_

NOTICE IS HEREBY GIVEN that the CHL - 17 lode mining claim has been located by Amazona Enterprises

whose current mailing address is

1846 E. Innovation Park Dr. STE 100

Oro Valley, AZ 85755.

The general course of this claim is north-south and it is situated in Mohave County, Arizona. This claim is 1500 feet in length and 600 feet in width.

20 Total Claim Acreage.

RECEIVED  
BLM AZ STATE OFFICE  
2018 DEC - 3 P 3:08  
PHOENIX, ARIZONA

This claim runs from the location monument on which this location notice is posted on the centerline of the claim approximately 100 feet in a north direction to the north end line and 300 feet in a west direction to the west end line and 1500 feet south to the south end line and 600 feet east to the east end line and 1500 feet north to the north end line. This claim is marked by six monuments, one at each corner and one at the center of each end line of the claim.

The location monument on which this notice is posted is situated within Section 8 in Township 23 North, Range 18 W, Gila Salt River Base and Meridian (GSRBM), Arizona and this claim encompasses portions of the following quarter section(s), section(s), Township(s) and Range(s) NW and SW¼ of Section 8 in Township 23 N, R 18 W of the GSRBM, Arizona.

The locality of this claim with reference to some natural object or permanent monument and additional information (if any) concerning its locality are as follows:

2,191 feet S 43° E from the NW corner of Section 8 in T 23 N, R 18 W of the GSRBM.

The above information is shown on the attached map.

DATED AND POSTED on the ground this 12 day of September, 2018.

LOCATOR(s)  AGENT

Print Name(s) William Feyerabend

Signature(s) William Feyerabend

AMC452661

RECEIVED  
BLM AZ STATE OFFICE

2010 DEC - 3 P 3:08

PHOENIX, ARIZONA

**MINING CLAIM MAP**

Lode ( )

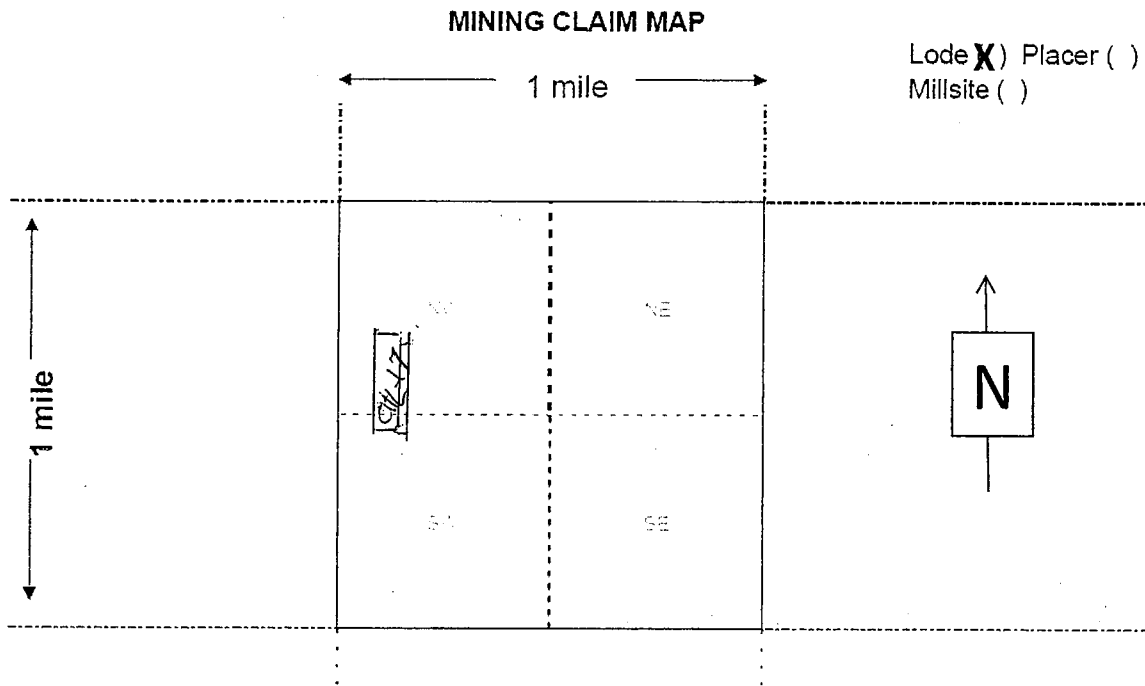

AN0452661

1. The above map depicts the CHL-17 mining claim, which is located in Section 8, Township 23 N., Range 18 W, Gila and Salt River Base and Meridian, Mohave County, Arizona. Total claim acreage is 20.
2. The type of corner and location monuments used are as follows: 2" X 2" X 4' wooden posts
3. The bearings and distances in degrees and feet between this location monument to a public land survey monument is 2,191 feet S 43° E from the NW corner of Sec. 8, T. 23 N., R. 18 W., GSRBM. as depicted on the map.





FEE# 2018059316

OFFICIAL RECORDS  
OF MOHAVE COUNTY  
KRISTI BLAIR,  
COUNTY RECORDER



11/30/2018 03:26 PM Fee: \$10.00

PAGE: 1 of 2

RECEIVED  
BLM AZ STATE OFFICE  
2018 DEC -3 P 3:08  
PHOENIX, ARIZONA

2

**LOCATION NOTICE FOR LODE MINING CLAIM**

Amendment BLM Serial # \_\_\_\_\_

NOTICE IS HEREBY GIVEN that the CHL - 18 lode mining claim has been located by Amazona Enterprises

whose current mailing address is

1846 E. Innovation Park Dr. STE 100

Oro Valley, AZ 85755.

The general course of this claim is north-south and it is situated in Mohave County, Arizona. This claim is 1500 feet in length and 600 feet in width.

20 Total Claim Acreage.

This claim runs from the location monument on which this location notice is posted on the centerline of the claim approximately 100 feet in a north direction to the north end line and 300 feet in a west direction to the west end line and 1500 feet south to the south end line and 600 feet east to the east end line and 1500 feet north to the north end line. This claim is marked by six monuments, one at each corner and one at the center of each end line of the claim.

The location monument on which this notice is posted is situated within Section 8 in Township 23 North, Range 18 W, Gila Salt River Base and Meridian (GSRBM), Arizona and this claim encompasses portions of the following quarter section(s), section(s), Township(s) and Range(s) NW and SW¼ of Section 8 in Township 23 N, R 18 W of the GSRBM, Arizona.

The locality of this claim with reference to some natural object or permanent monument and additional information (if any) concerning its locality are as follows:  
2,639 feet S 52° E from the NW corner of Section 8 in T 23 N, R 18 W of the GSRBM.

The above information is shown on the attached map.

DATED AND POSTED on the ground this 11 day of September, 2018.

LOCATOR(s)  AGENT

Print Name(s) William Feyerabend  
Signature(s) William Feyerabend

AMC452662

RECEIVED  
BLM AZ STATE OFFICE

2010 DEC - 3 P 3:08

PHOENIX, ARIZONA

**MINING CLAIM MAP**  
Lode ( )

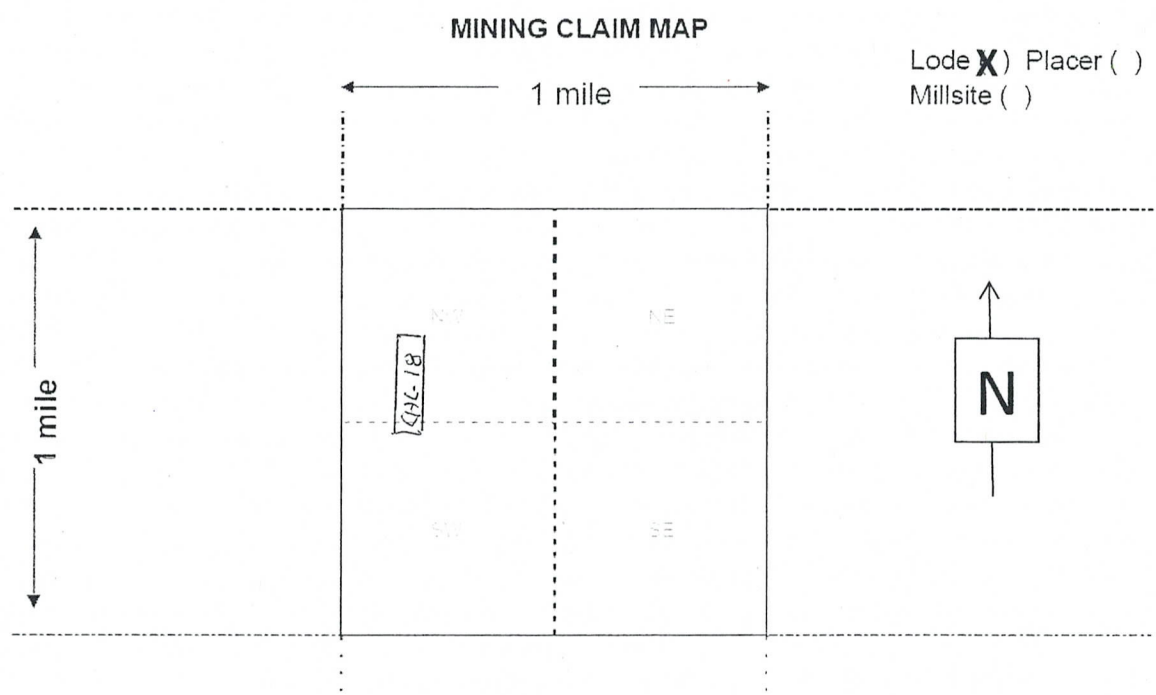

AM0452662

1. The above map depicts the CHL-18 mining claim, which is located in Section 8, Township 23 N, Range 18 W, Gila and Salt River Base and Meridian, Mohave County, Arizona. Total claim acreage is 20.
2. The type of corner and location monuments used are as follows: 2" X 2" X 4' wooden posts
3. The bearings and distances in degrees and feet between this location monument to a public land survey monument is 2,639 feet S 52° E from the NW corner of Sec. 8, T. 23 N., R. 18 W., GSRBM. as depicted on the map.

FEE# 2018059317

OFFICIAL RECORDS  
OF MOHAVE COUNTY  
KRISTI BLAIR,  
COUNTY RECORDER



11/30/2018 03:26 PM Fee: \$10.00

PAGE: 1 of 2

2

**LOCATION NOTICE FOR LODE MINING CLAIM**

Amendment BLM Serial # \_\_\_\_\_

NOTICE IS HEREBY GIVEN that the CHL - 19 lode mining claim has been located by Amazona Enterprises whose current mailing address is

1846 E. Innovation Park Dr. STE 100  
Oro Valley, AZ 85755.

The general course of this claim is north-south and it is situated in Mohave County, Arizona. This claim is 1500 feet in length and 600 feet in width.  
20 Total Claim Acreage.

RECEIVED  
BLM AZ STATE OFFICE  
2018 DEC - 3 P 3:08  
PHOENIX, ARIZONA

This claim runs from the location monument on which this location notice is posted on the centerline of the claim approximately 100 feet in a north direction to the north end line and 300 feet in a west direction to the west end line and 1500 feet south to the south end line and 600 feet east to the east end line and 1500 feet north to the north end line. This claim is marked by six monuments, one at each corner and one at the center of each end line of the claim.

The location monument on which this notice is posted is situated within Section 8 in Township 23 North, Range 18 W, Gila Salt River Base and Meridian (GSRBM), Arizona and this claim encompasses portions of the following quarter section(s), section(s), Township(s) and Range(s) NW, NE, SW and SE 1/4 of Section 8 in Township 23 N, R 18 W of the GSRBM, Arizona.

The locality of this claim with reference to some natural object or permanent monument and additional information (if any) concerning its locality are as follows:  
3,137 feet S 59° E from the NW corner of Section 8 in T 23 N, R 18 W of the GSRBM.

The above information is shown on the attached map.

DATED AND POSTED on the ground this 11 day of September, 2018.

LOCATOR(s)  AGENT

Print Name(s) William Feyerabend  
Signature(s) William Feyerabend

AMC452663

RECEIVED  
BLM AZ STATE OFFICE

2010 DEC - 3 P 3:08

PHOENIX, ARIZONA

**MINING CLAIM MAP**  
Lode ( )

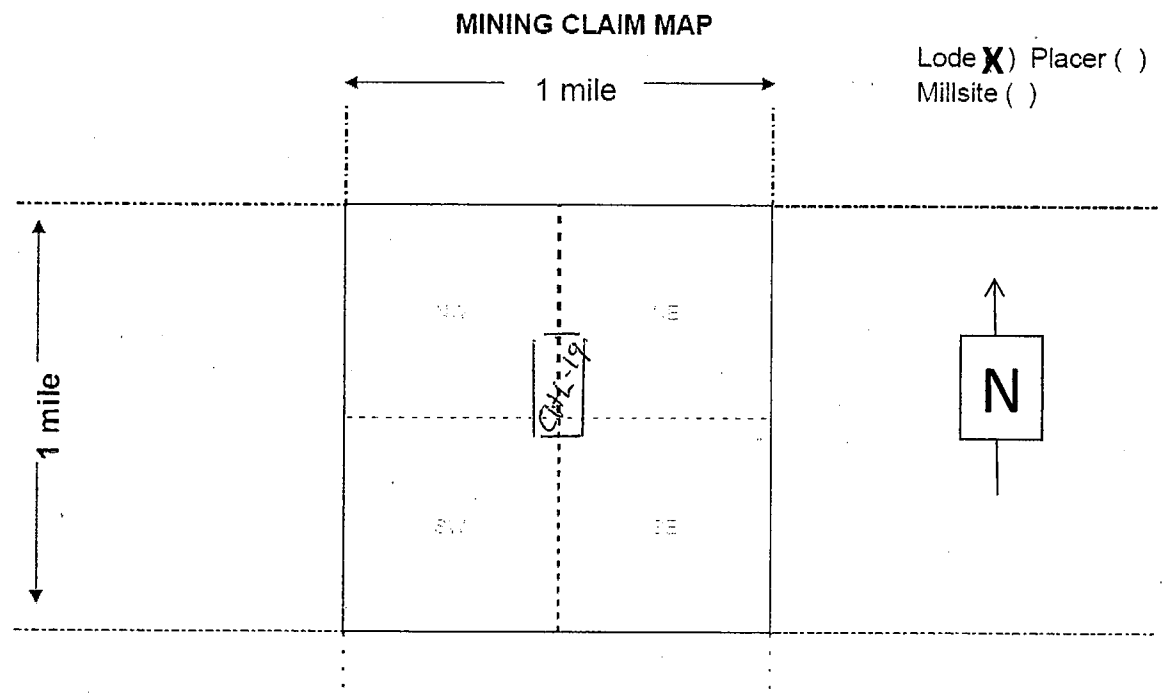

AMC452663

1. The above map depicts the CHL-19 mining claim, which is located in Section 8, Township 23 N, Range 18 W, Gila and Salt River Base and Meridian, Mohave County, Arizona. Total claim acreage is 20.
2. The type of corner and location monuments used are as follows: 2" X 2" X 4' wooden posts
3. The bearings and distances in degrees and feet between this location monument to a public land survey monument is 3,137 feet S 59° E from the NW corner of Sec. 8, T. 23 N., R. 18 W., GSRBM. as depicted on the map.



FEE# 2018059318

OFFICIAL RECORDS  
OF MOHAVE COUNTY  
KRISTI BLAIR,  
COUNTY RECORDER



11/30/2018 03:26 PM Fee: \$10.00

PAGE: 1 of 2

2

LOCATION NOTICE FOR LODE MINING CLAIM

Amendment BLM Serial # \_\_\_\_\_

NOTICE IS HEREBY GIVEN that the CHL - 20 lode mining claim has been located by Amazona Enterprises whose current mailing address is

1846 E. Innovation Park Dr. STE 100  
Oro Valley, AZ 85755.

The general course of this claim is north-south and it is situated in Mohave County, Arizona. This claim is 1500 feet in length and 600 feet in width.

20 Total Claim Acreage.

RECEIVED  
BLM AZ STATE OFFICE  
2018 DEC - 3 P 3:08  
PHOENIX, ARIZONA

This claim runs from the location monument on which this location notice is posted on the centerline of the claim approximately 100 feet in a north direction to the north end line and 300 feet in a west direction to the west end line and 1500 feet south to the south end line and 600 feet east to the east end line and 1500 feet north to the north end line. This claim is marked by six monuments, one at each corner and one at the center of each end line of the claim.

The location monument on which this notice is posted is situated within Section 8 in Township 23 North, Range 18 W, Gila Salt River Base and Meridian (GSRBM), Arizona and this claim encompasses portions of the following quarter section(s), section(s), Township(s) and Range(s) NE and SE $\frac{1}{4}$  of Section 8 in Township 23 N, R 18 W of the GSRBM, Arizona.

The locality of this claim with reference to some natural object or permanent monument and additional information (if any) concerning its locality are as follows:  
3,667 feet S 64° E from the NW corner of Section 8 in T 23 N, R 18 W of the GSRBM.

The above information is shown on the attached map.

DATED AND POSTED on the ground this 11 day of September, 2018.

LOCATOR(s)  AGENT

Print Name(s) William Feyerabend

Signature(s) William Feyerabend

AMC452664

PHOENIX, ARIZONA

2010 DEC - 3 P 3:08

RECEIVED  
BLM AZ STATE OFFICE

**MINING CLAIM MAP**

Lode ( )

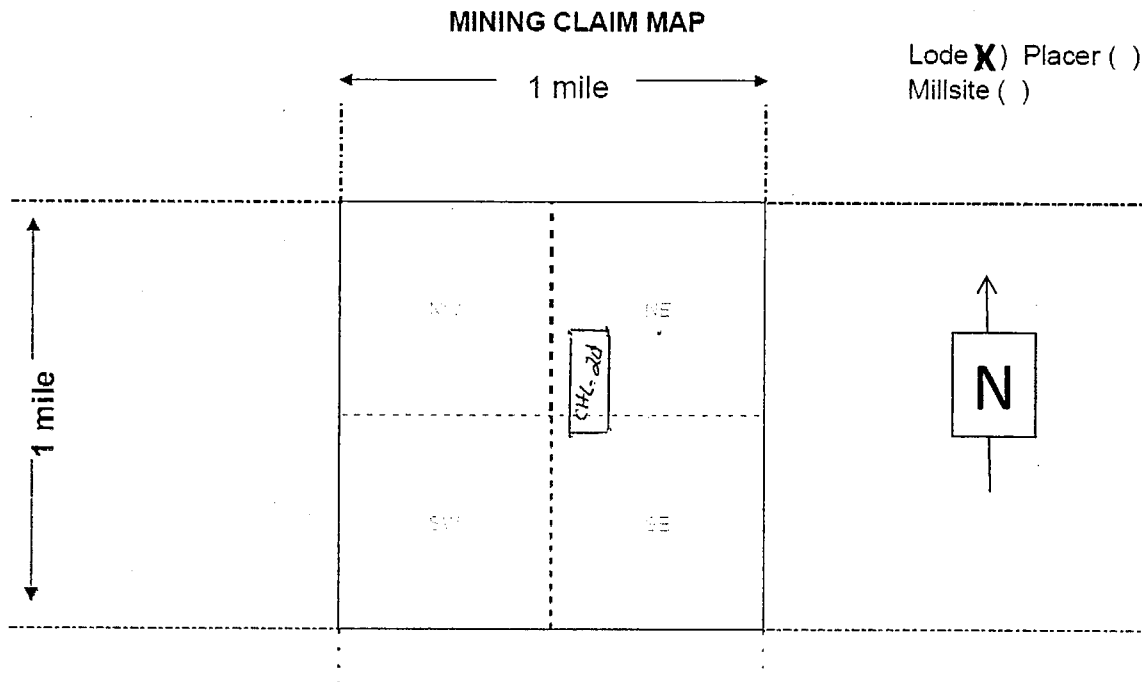

AMC452664

1. The above map depicts the CHL-20 mining claim, which is located in Section 8, Township 23 N, Range 18 W, Gila and Salt River Base and Meridian, Mohave County, Arizona. Total claim acreage is 20.
2. The type of corner and location monuments used are as follows: 2" X 2" X 4' wooden posts
3. The bearings and distances in degrees and feet between this location monument to a public land survey monument is 3,667 feet S 64° E from the NW corner of Sec. 8, T. 23 N., R. 18 W., GSRBM. as depicted on the map.

FEE# 2018059319

OFFICIAL RECORDS  
OF MOHAVE COUNTY  
KRISTI BLAIR,  
COUNTY RECORDER



11/30/2018 03:26 PM Fee: \$10.00

PAGE: 1 of 2

2

LOCATION NOTICE FOR LODE MINING CLAIM

Amendment BLM Serial # \_\_\_\_\_

NOTICE IS HEREBY GIVEN that the CHL - 21 lode mining claim has been located by Amazona Enterprises whose current mailing address is

1846 E. Innovation Park Dr. STE 100  
Oro Valley, AZ 85755.

The general course of this claim is north-south and it is situated in Mohave County, Arizona. This claim is 1500 feet in length and 600 feet in width.

20 Total Claim Acreage.

This claim runs from the location monument on which this location notice is posted on the centerline of the claim approximately 100 feet in a north direction to the north end line and 300 feet in a west direction to the west end line and 1500 feet south to the south end line and 600 feet east to the east end line and 1500 feet north to the north end line. This claim is marked by six monuments, one at each corner and one at the center of each end line of the claim.

The location monument on which this notice is posted is situated within Section 8 in Township 23 North, Range 18 W, Gila Salt River Base and Meridian (GSRBM), Arizona and this claim encompasses portions of the following quarter section(s), section(s), Township(s) and Range(s) NE and SE $\frac{1}{4}$  of Section 8 in Township 23 N, R 18 W of the GSRBM, Arizona.

The locality of this claim with reference to some natural object or permanent monument and additional information (if any) concerning its locality are as follows:  
4,215 feet S 68° E from the NW corner of Section 8 in T 23 N, R 18 W of the GSRBM.

The above information is shown on the attached map.

DATED AND POSTED on the ground this 11 day of September, 2018.

LOCATOR(s)  AGENT

Print Name(s) William Feyerabend

Signature(s) William Feyerabend

RECEIVED  
BLM AZ STATE OFFICE  
2018 DEC -3 P 3:08  
PHOENIX, ARIZONA

AMC452665

RECEIVED  
BLM AZ STATE OFFICE

2010 DEC - 3 P 3:08

PHOENIX, ARIZONA

**MINING CLAIM MAP**  
Lode ( )

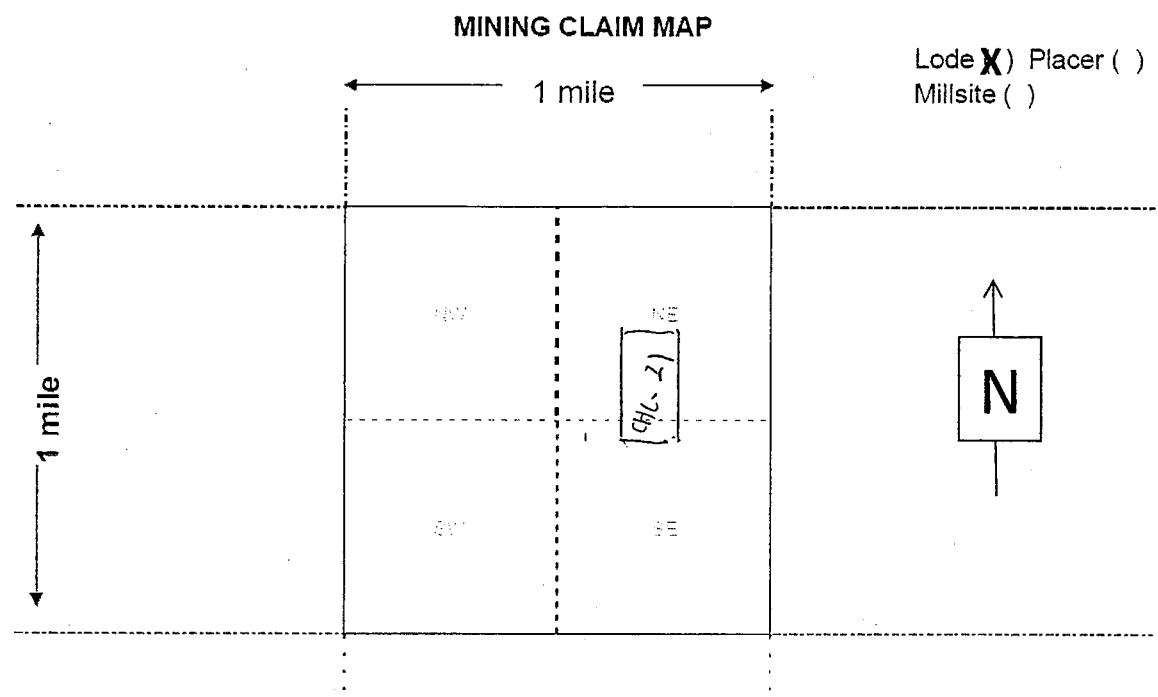

AMC452665

1. The above map depicts the CHL-21 mining claim, which is located in Section 8, Township 23 N, Range 18 W, Gila and Salt River Base and Meridian, Mohave County, Arizona. Total claim acreage is 20.
2. The type of corner and location monuments used are as follows: 2" X 2" X 4' wooden posts
3. The bearings and distances in degrees and feet between this location monument to a public land survey monument is 4,215 feet S 68° E from the NW corner of Sec. 8, T. 23 N., R. 18 W., GSRBM. as depicted on the map.



FEE# 2018059320

OFFICIAL RECORDS  
OF MOHAVE COUNTY  
KRISTI BLAIR,  
COUNTY RECORDER



11/30/2018 03:26 PM Fee: \$10.00

PAGE: 1 of 2

2

**LOCATION NOTICE FOR LODE MINING CLAIM**

Amendment BLM Serial # \_\_\_\_\_

NOTICE IS HEREBY GIVEN that the CHL - 22 lode mining claim has been located by Amazona Enterprises whose current mailing address is

1846 E. Innovation Park Dr. STE 100  
Oro Valley, AZ 85755.

The general course of this claim is north-south and it is situated in Mohave County, Arizona. This claim is 1500 feet in length and 600 feet in width.

20 Total Claim Acreage.

RECEIVED  
BLM AZ STATE OFFICE  
2018 DEC - 3 P 3:08  
PHOENIX, ARIZONA

This claim runs from the location monument on which this location notice is posted on the centerline of the claim approximately 100 feet in a south direction to the south end line and 300 feet in a west direction to the west end line and 1500 feet north to the north end line and 600 feet east to the east end line and 1500 feet south to the south end line. This claim is marked by six monuments, one at each corner and one at the center of each end line of the claim.

The location monument on which this notice is posted is situated within Section 8 in Township 23 North, Range 18 W, Gila Salt River Base and Meridian (GSRBM), Arizona and this claim encompasses portions of the following quarter section(s), section(s), Township(s) and Range(s) NE and SE 1/4 of Section 8 in Township 23 N, R 18 W of the GSRBM, Arizona.

The locality of this claim with reference to some natural object or permanent monument and additional information (if any) concerning its locality are as follows:  
5,355 feet S 57° E from the NW corner of Section 8 in T 23 N, R 18 W of the GSRBM.

The above information is shown on the attached map.

DATED AND POSTED on the ground this 26 day of November, 2018 1.

LOCATOR(s)  AGENT

Print Name(s) William Feyerabend

Signature(s) William Feyerabend

AMC452666

RECEIVED  
 BLM AZ STATE OFFICE  
 2010 DEC - 3 P 3:08  
 PHOENIX, ARIZONA

**MINING CLAIM MAP**

Lode ( )

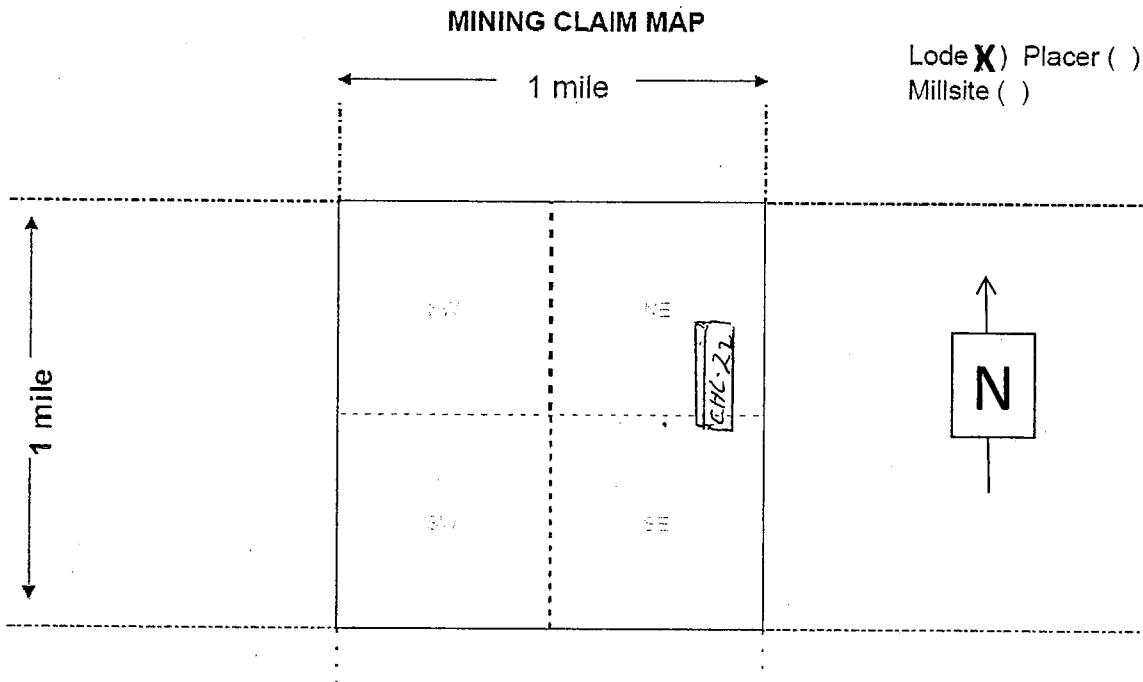

AMC452666

1. The above map depicts the CHL-22 mining claim, which is located in Section 8, Township 23 N, Range 18 W, Gila and Salt River Base and Meridian, Mohave County, Arizona. Total claim acreage is 20.
2. The type of corner and location monuments used are as follows: 2" X 2" X 4' wooden posts
3. The bearings and distances in degrees and feet between this location monument to a public land survey monument is 5,355 feet S 57° E from the NW corner of Sec. 8, T. 23 N., R. 18 W., GSRBM. as depicted on the map.



# LR2000 Internal

## CR Geographic Report with Land

### Download User Guide (pdf)

**Purpose:** This report produces a geographic listing of case information based on retrieval by Meridian/Township/Range. This report format will display the case type, case disposition, meridian, township, range, section, survey type, survey number, surface management agency, pending actions, serial number, and total case acres.

To refresh the query, do a **Ctrl-R**. It resets the page and clears any criteria fields that may have entries.



### No Results

The specified criteria didn't result in any data. This is often caused by applying filters and/or selection steps that are too restrictive or that contain incorrect values. Please check your analysis filters and selection steps, and try again. The filters or selection steps currently being applied are shown below.

#### Filters

Disposition is equal to **AUTHORIZED, CANCELLED, EXPIRED, PENDING, REJECTED, RELINQUISHED, WITHDRAWN**  
**and** Meridian Township Range Section is equal to **14 0230N 0180W 005 SW**  
**and** Admin State is equal to **AZ**

[Return - Refresh](#)



# LR2000 Internal

## CR Geographic Report with Land

### [Download User Guide \(pdf\)](#)

**Purpose:** This report produces a geographic listing of case information based on retrieval by Meridian/Township/Range. This report format will display the case type, case disposition, meridian, township, range, section, survey type, survey number, surface management agency, pending actions, serial number, and total case acres.

To refresh the query, do a **Ctrl-R**. It resets the page and clears any criteria fields that may have entries.



### No Results

The specified criteria didn't result in any data. This is often caused by applying filters and/or selection steps that are too restrictive or that contain incorrect values. Please check your analysis filters and selection steps, and try again. The filters or selection steps currently being applied are shown below.

#### Filters

Disposition is equal to **AUTHORIZED, CANCELLED, EXPIRED, PENDING, REJECTED, RELINQUISHED, WITHDRAWN**  
**and** Meridian Township Range Section is equal to **14 0230N 0180W 005 SW**  
**and** Admin State is equal to **AZ**

[Return - Refresh](#)





# LR2000 Internal

## CR Geographic Report with Land

[Download User Guide \(pdf\)](#)

**Purpose:** This report produces a geographic listing of case information based on retrieval by Meridian/Township/Range. This report format will display the case type, case disposition, meridian, township, range, section, survey type, survey number, surface management agency, pending actions, serial number, and total case acres.

To refresh the query, do a **Ctrl-R**. It resets the page and clears any criteria fields that may have entries.



### No Results

The specified criteria didn't result in any data. This is often caused by applying filters and/or selection steps that are too restrictive or that contain incorrect values. Please check your analysis filters and selection steps, and try again. The filters or selection steps currently being applied are shown below.

#### Filters

Disposition is equal to **AUTHORIZED, CANCELLED, EXPIRED, PENDING, REJECTED, RELINQUISHED, WITHDRAWN**  
and Meridian Township Range Section is equal to **14 0230N 0180W 005 SE**  
and Admin State is equal to **AZ**

[Return - Refresh](#)



# LR2000 Internal

## CR Geographic Report with Land

### Download User Guide (pdf)

**Purpose:** This report produces a geographic listing of case information based on retrieval by Meridian/Township/Range. This report format will display the case type, case disposition, meridian, township, range, section, survey type, survey number, surface management agency, pending actions, serial number, and total case acres.

To refresh the query, do a **Ctrl-R**. It resets the page and clears any criteria fields that may have entries.



### No Results

The specified criteria didn't result in any data. This is often caused by applying filters and/or selection steps that are too restrictive or that contain incorrect values. Please check your analysis filters and selection steps, and try again. The filters or selection steps currently being applied are shown below.

#### Filters

Disposition is equal to **AUTHORIZED, CANCELLED, EXPIRED, PENDING, REJECTED, RELINQUISHED, WITHDRAWN**  
**and** Meridian Township Range Section is equal to **14 0230N 0180W 008 NW**  
**and** Admin State is equal to **AZ**

[Return - Refresh](#)



# LR2000 Internal

## CR Geographic Report with Land

### Download User Guide (pdf)

**Purpose:** This report produces a geographic listing of case information based on retrieval by Meridian/Township/Range. This report format will display the case type, case disposition, meridian, township, range, section, survey type, survey number, surface management agency, pending actions, serial number, and total case acres.

To refresh the query, do a **Ctrl-R**. It resets the page and clears any criteria fields that may have entries.



### No Results

The specified criteria didn't result in any data. This is often caused by applying filters and/or selection steps that are too restrictive or that contain incorrect values. Please check your analysis filters and selection steps, and try again. The filters or selection steps currently being applied are shown below.

#### Filters

Disposition is equal to **AUTHORIZED, CANCELLED, EXPIRED, PENDING, REJECTED, RELINQUISHED, WITHDRAWN**  
**and** Meridian Township Range Section is equal to **14 0230N 0180W 008 NW**  
**and** Admin State is equal to **AZ**

[Return - Refresh](#)





# LR2000 Internal

## CR Geographic Report with Land

[Download User Guide \(pdf\)](#)

**Purpose:** This report produces a geographic listing of case information based on retrieval by Meridian/Township/Range. This report format will display the case type, case disposition, meridian, township, range, section, survey type, survey number, surface management agency, pending actions, serial number, and total case acres.

To refresh the query, do a **Ctrl-R**. It resets the page and clears any criteria fields that may have entries.



### No Results

The specified criteria didn't result in any data. This is often caused by applying filters and/or selection steps that are too restrictive or that contain incorrect values. Please check your analysis filters and selection steps, and try again. The filters or selection steps currently being applied are shown below.

#### Filters

Disposition is equal to **AUTHORIZED, CANCELLED, EXPIRED, PENDING, REJECTED, RELINQUISHED, WITHDRAWN**  
and Meridian Township Range Section is equal to **14 0230N 0180W 008 NE**  
and Admin State is equal to **AZ**

[Return](#) - Refresh





# LR2000 Internal

## CR Geographic Report with Land

[Download User Guide \(pdf\)](#)

**Purpose:** This report produces a geographic listing of case information based on retrieval by Meridian/Township/Range. This report format will display the case type, case disposition, meridian, township, range, section, survey type, survey number, surface management agency, pending actions, serial number, and total case acres.

To refresh the query, do a **Ctrl-R**. It resets the page and clears any criteria fields that may have entries.

[info icon] **No Results**

The specified criteria didn't result in any data. This is often caused by applying filters and/or selection steps that are too restrictive or that contain incorrect values. Please check your analysis filters and selection steps, and try again. The filters or selection steps currently being applied are shown below.

**Filters**

Disposition is equal to **AUTHORIZED, CANCELLED, EXPIRED, PENDING, REJECTED, RELINQUISHED, WITHDRAWN**  
**and** Meridian Township Range Section is equal to **14 0230N 0180W 008 NE**  
**and** Admin State is equal to **AZ**

[Return - Refresh](#)

LR2K Home CR-24



# LR2000 Internal

## CR Geographic Report with Land

[Download User Guide \(pdf\)](#)

**Purpose:** This report produces a geographic listing of case information based on retrieval by Meridian/Township/Range. This report format will display the case type, case disposition, meridian, township, range, section, survey type, survey number, surface management agency, pending actions, serial number, and total case acres.

To refresh the query, do a **Ctrl-R**. It resets the page and clears any criteria fields that may have entries.



### No Results

The specified criteria didn't result in any data. This is often caused by applying filters and/or selection steps that are too restrictive or that contain incorrect values. Please check your analysis filters and selection steps, and try again. The filters or selection steps currently being applied are shown below.

#### Filters

Disposition is equal to **AUTHORIZED, CANCELLED, EXPIRED, PENDING, REJECTED, RELINQUISHED, WITHDRAWN**  
and Meridian Township Range Section is equal to **14 0230N 0180W 008 NW**  
and Admin State is equal to **AZ**

[Return - Refresh](#)

LR2K Home CR-24 [gear icon] [help icon]



# LR2000 Internal

## CR Geographic Report with Land

[Download User Guide \(pdf\)](#)

**Purpose:** This report produces a geographic listing of case information based on retrieval by Meridian/Township/Range. This report format will display the case type, case disposition, meridian, township, range, section, survey type, survey number, surface management agency, pending actions, serial number, and total case acres.

To refresh the query, do a **Ctrl-R**. It resets the page and clears any criteria fields that may have entries.

**No Results**

The specified criteria didn't result in any data. This is often caused by applying filters and/or selection steps that are too restrictive or that contain incorrect values. Please check your analysis filters and selection steps, and try again. The filters or selection steps currently being applied are shown below.

**Filters**

Disposition is equal to **AUTHORIZED, CANCELLED, EXPIRED, PENDING, REJECTED, RELINQUISHED, WITHDRAWN**  
**and** Meridian Township Range Section is equal to **14 0230N 0180W 008 SW**  
**and** Admin State is equal to **AZ**

[Return - Refresh](#)





# LR2000 Internal

## CR Geographic Report with Land

[Download User Guide \(pdf\)](#)

**Purpose:** This report produces a geographic listing of case information based on retrieval by Meridian/Township/Range. This report format will display the case type, case disposition, meridian, township, range, section, survey type, survey number, surface management agency, pending actions, serial number, and total case acres.

To refresh the query, do a **Ctrl-R**. It resets the page and clears any criteria fields that may have entries.



### No Results

The specified criteria didn't result in any data. This is often caused by applying filters and/or selection steps that are too restrictive or that contain incorrect values. Please check your analysis filters and selection steps, and try again. The filters or selection steps currently being applied are shown below.

#### Filters

Disposition is equal to **AUTHORIZED, CANCELLED, EXPIRED, PENDING, REJECTED, RELINQUISHED, WITHDRAWN**  
**and** Meridian Township Range Section is equal to **14 0230N 0180W 008 NE**  
**and** Admin State is equal to **AZ**

[Return - Refresh](#)





# LR2000 Internal

## CR Geographic Report with Land

[Download User Guide \(pdf\)](#)

**Purpose:** This report produces a geographic listing of case information based on retrieval by Meridian/Township/Range. This report format will display the case type, case disposition, meridian, township, range, section, survey type, survey number, surface management agency, pending actions, serial number, and total case acres.

To refresh the query, do a **Ctrl-R**. It resets the page and clears any criteria fields that may have entries.



### No Results

The specified criteria didn't result in any data. This is often caused by applying filters and/or selection steps that are too restrictive or that contain incorrect values. Please check your analysis filters and selection steps, and try again. The filters or selection steps currently being applied are shown below.

#### Filters

Disposition is equal to **AUTHORIZED, CANCELLED, EXPIRED, PENDING, REJECTED, RELINQUISHED, WITHDRAWN**  
**and** Meridian Township Range Section is equal to **14 0230N 0180W 008 SE**  
**and** Admin State is equal to **AZ**

[Return - Refresh](#)

# TOWNSHIP 23 NORTH RANGE 18 WEST OF THE GILA AND SALT RIVER MERIDIAN, ARIZONA

MOHAVE COUNTY  
KINGMAN FIELD OFFICE

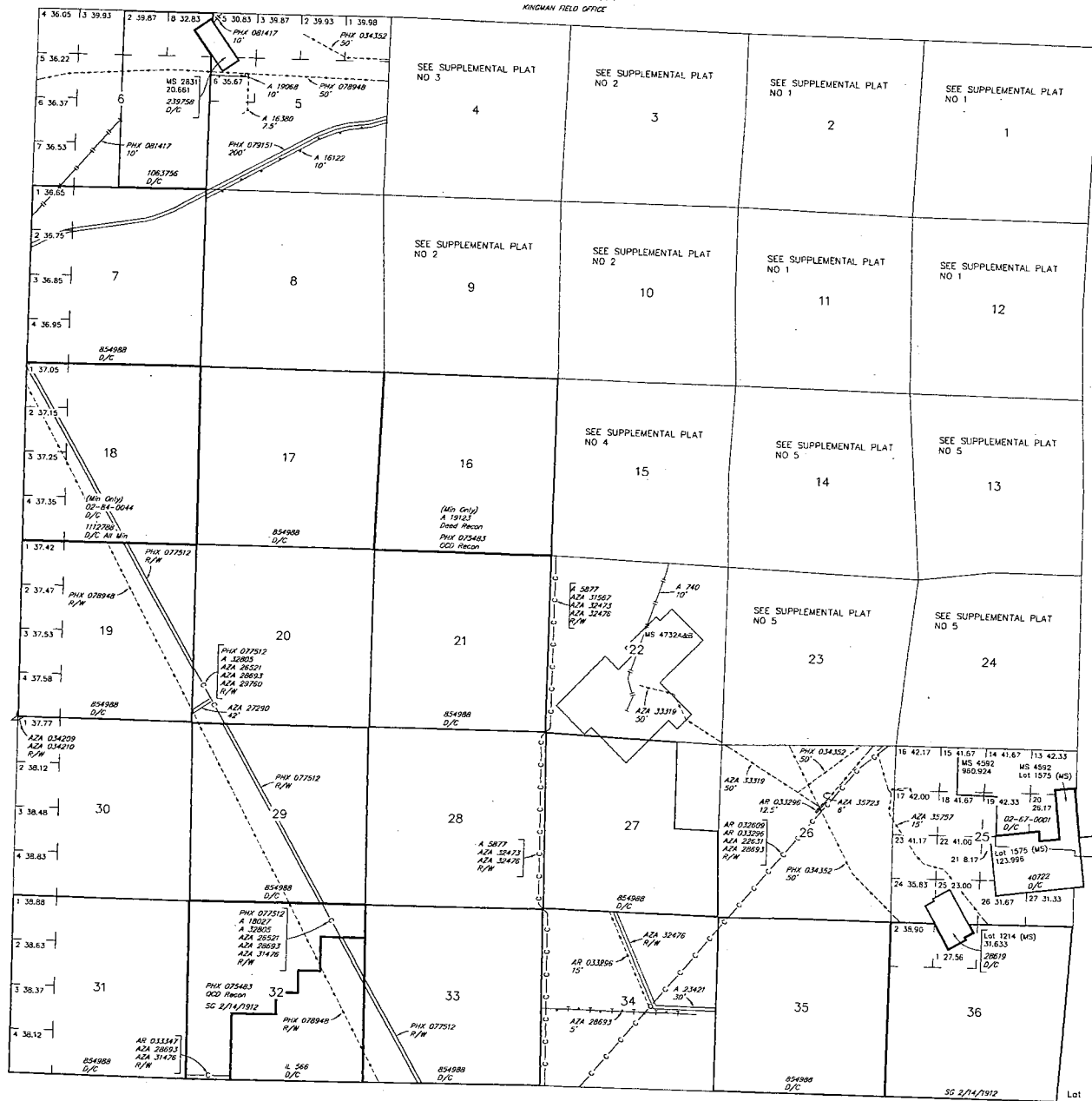

STATUS OF PUBLIC DOMAIN  
LAND AND MINERAL TITLES

INDEX TO SEGREGATED TRACTS				
RESERVE/KEY	ORIGINAL SURVEY			
	TRACT NO	T	R	SEC

*FOR ORDERS AFFECTING DISPOSAL OR USE OF UNIDENTIFIED LANDS WITHDRAWN FOR CLASSIFICATION, MINERALS, WATER AND/OR OTHER PUBLIC PURPOSES, REFER TO INDEX OF MISCELLANEOUS DOCUMENTS.*

*Grazing Dist No 2*

*MDS 451 NE  
452 NW  
453 SW  
454 SE*

*AR 033343 R/W Pipeline 25'  
Sec 24: Lot 7*

*AZA 27301 R/W Road  
Sec 20: NW1/4 M&B*

*AZA 30121 R/W Telephone & Telegraph 10'  
Sec 22: NW1/4SW1/4, SW1/4SW1/4SW1/4SW1/4*

*AZA 31000 R/W Precipitation Gauge  
Sec 34: NW/NE1/4NW1/4*

*AZA 31001 R/W Precipitation Gauge  
Sec 12: SW/NE1/4NW1/4*

*AZA 33610 R/W Pipeline 3'  
Sec 4: Lots 4, 16, 20, NE1/4SW1/4NW1/4  
NW1/2SE1/4NW1/4*

*AZA 36143 R/W Transmission Line 10'  
Sec 4: Lots 16 & 20*

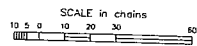

**WARNING STATEMENT**  
This plat is the Bureau's Record of Title, and should be used only as a graphic display of the township survey data. Recorders do not reflect title changes which may have been effected by lateral movements of rivers or other bodies of water. Refer to the cadastral surveys for official survey information.

CURRENT TO	NW	CSR Mer
5-18-2015	ACAD	T 23 N R 18 W

TOWNSHIP 02 NORTH RANGE 14 EAST OF THE GILA & SALT RIVER MERIDIAN, ARIZONA

SECS	SUBDIVISION																Acres	Kind of Entry or Purpose	Serial Number or Order Number	Action Date	Remarks			
	NE 1/4				NW 1/4				SW 1/4				SE 1/4									Lots	Other Description	
	NE	NW	SW	SE	NE	NW	SW	SE	NE	NW	SW	SE	NE	NW	SW	SE								
For orders affecting disposal or use of unidentified lands withdrawn for classification, minerals, water, and/or other public purposes, and Indian treaties, refer to Index to Miscellaneous Documents																								
	ENTIRE TOWNSHIP																	13N 1E;		SO TEMP WDL RIO VERDE FOREST RESERVE		12/14/1901	CHANGED TO RIO VERDE NF ACT 3/4/1907; ENLGMT PROC 795, 1/13/1908;	
1																		M&B; SUBDIV UNDEF;		R/W TRANSMISSION LINE	PHX-086633	2/9/1904	1N 15E; CANC 6/28/1972;	
	ENTIRE TOWNSHIP																	7N 6E;		PROC ENLGMT TONTO NATIONAL FOREST	795	1/13/1908	TRFD TO CROOK NF PROC 816, 7/1/1908; TRFD TO TONTO NF PLO 924, 10/23/1953;	
																		ALL SECS 2, 16, 32, 36;		STATE GRANT	ACT OF CONGRESS	6/20/1910	TITLE TO STATE TO FIX ON APPROVAL OF SURVEY; SUBJECT TO PRIOR RIGHTS;	
																		SENESE, N2SESE, SESESE;	40.00	PATENT / HE	149259	8/29/1910	2N 15E;	
1				X														S2NWNENE, SWNE, NESWNWNE, N2SEWNNE, SESEWNNE, E2E2SWNE, NENENWSE, N2NESE, N2SWNESE, SESWNESE;	105.00	PATENT / HE	151435	9/12/1910	2N 15E;	
1																		N2NWNE;	20.00	PATENT / HE	186189	3/27/1911	3N 14E;	
6																		M&B;	44.04	HE	PHX-023756	11/15/1913	REL 12/21/1917;	
6																		M&B;	44.04	HE	PHX-037498	12/21/1917	REL 3/13/1919;	
3																								
4																								
10																								
11																								
13																								
14																		M&B; SUBDIV UNDEF;		R/W TRANSMISSION AND TELEPHONE LINE	PHX-059578	4/13/1926	PERPETUAL; 4N 12E;	
																		ALL SECS 2, 16, 32, 36;		STATE GRANT	ACT OF CONGRESS	1/25/1927	EXTENDS ACT OF 6/20/1910 TO MINERAL LANDS; SUBJECT TO PRIOR RIGHTS;	
																		ALL;	640.00					
16																		ALL;	640.00	L BASE	180	9/6/1938	18N 14E;	
32																		ALL;	640.00					
36																		ALL;	640.00	L BASE	208	10/2/1940	12N 26E;	
3								X																
4	X	X	X	X	X														LD TP: 1S 15E;	240.00	APLN / WDL FS SUMMIT WATERSHEDS RESEARCH AREA	AR-010997	3/6/1956	WITHDRAWS THE LAND FROM LOCATION AND ENTRY UNDER THE GENERAL MINING LAWS; WDL PLO 3263, 10/29/1963;
	ENTIRE TOWNSHIP																			DETERMINATION AREA PL 167	AR-023734	12/31/1959	DET COMP 2/9/1962;	
3								X											40.00					

**Extremely Urgent**

This envelope is for use with the following services:

**UPS Next Day Air®**  
**UPS Worldwide Express<sup>SM</sup>**  
**UPS 2nd Day Air®**

Apply shipping documents on this side.

Visit [theupsstore.com](http://theupsstore.com) or call **1-800-PICK-UPS®** (1-800-742-5877) to find a location near you.

**Domestic Shipments**

- To qualify for the Letter rate, UPS Express Envelopes may only contain correspondence, urgent documents, and/or electronic media, and must weigh 8 oz. or less. UPS Express Envelopes containing items other than those listed or weighing more than 8 oz. will be billed by weight.

**International Shipments**

- The UPS Express Envelope may be used only for documents of no commercial value. Certain countries consider electronic media as documents. Visit [ups.com/importexport](http://ups.com/importexport) to verify if your shipment is classified as a document.
- To qualify for the letter rate, the UPS Express Envelope must weigh 8 oz. or less. UPS Express Envelopes weighing more than 8 oz. will be billed by weight.

Note: Express Envelopes are not to be used for shipping items containing cash or cash equivalents.

1 LBS 1 OF 1  
SHP WT: 1 LBS  
DATE: 30 NOV 2018

BILL FEYERABEND  
(928) 830-0721  
THE UPS STORE #5241  
STE 103  
3880 STOCKTON HILL RD  
KINGMAN AZ 86409-0596

SHIP BLM STATE OFFICE  
TO: STE 800  
1 N CENTRAL AVE

PHOENIX AZ 85004-4427

**AZ 850 9-10**

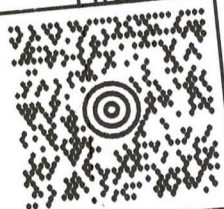

**UPS GROUND**

TRACKING #: 1Z R03 8X0 03 2411 7314



BILLING: P/P

REF #1: 113018DW  
REF #2: 5241

ISH 13.00N ZP 450 06.5U 10/2018

SEE NOTICE ON REVERSE regarding UPS terms, and notice of limitation of liability. Where allowed by law, shipper authorizes UPS to act as forwarding agent for export control and customs purposes. If exported from the US, shipper certifies that the commodities, technology or software were exported from the US in accordance with the Export Administration Regulations. Diversion contrary to law is prohibited. 8500 022 1118

RECEIVED  
BLM AZ STATE OFFICE  
2018 DEC - 3 P 3: 09  
PHOENIX, ARIZONA

Serving you for more than 100 years  
United Parcel Service.





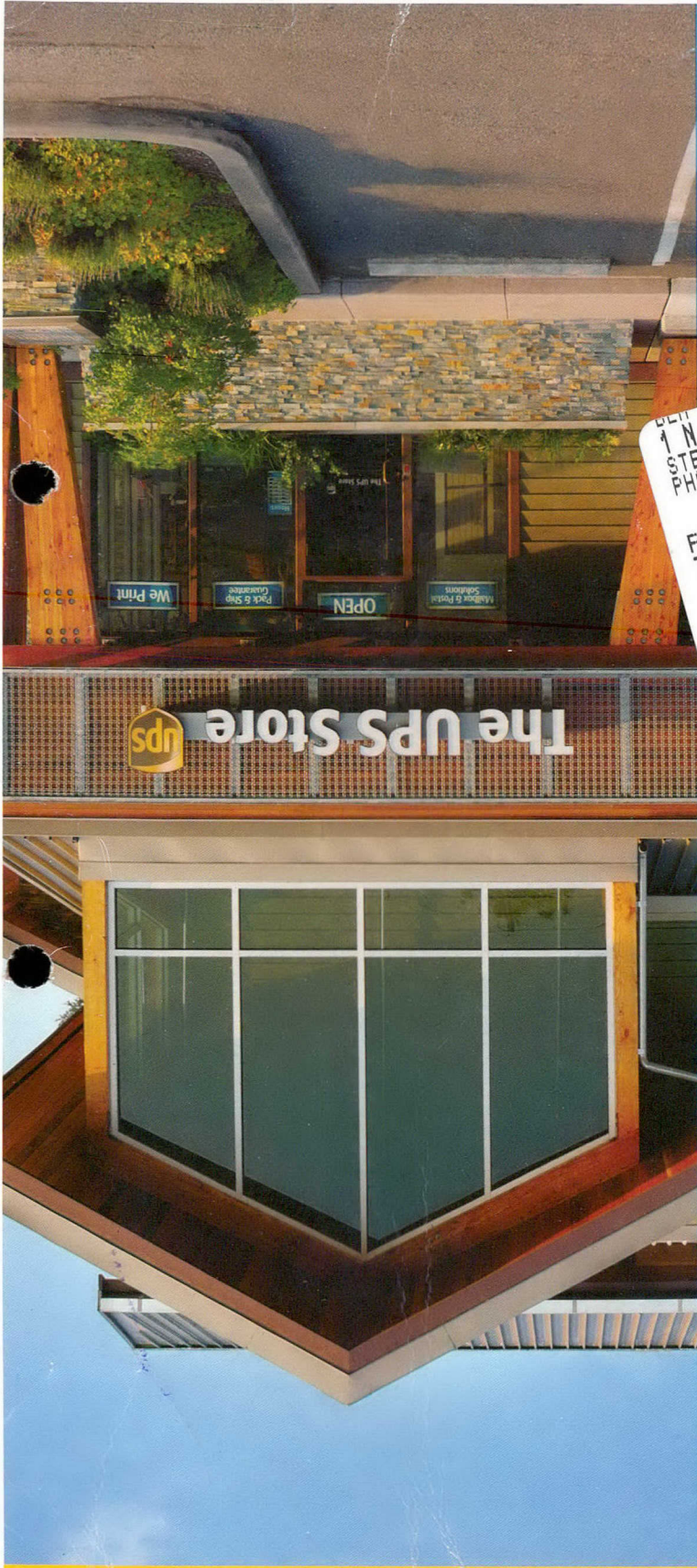

theupsstore.com • theupsstorefranchise.com

1 N CENTRAL AVE  
STE 800  
PHOENIX AZ 85004-4414  
P#: BROWN S: ORANGE I:  
1004-6418  
1ZR038X0032411 7314  
SAT08485 Dec 1 06:20:50 2018  
US 8501 HIIPS 18.05. SAT08485L

Print & Business Services



The UPS Store

EXPLORE